

PIAZZA GRAFIC HINGED DOORS

TYPE 2: FRAME WITH ARCHITRAVES , OR FLUSH WITH THE WALL



EXTERNAL OFFSET
OR
HIDDEN PIVOT HINGES



MAGNETIC LATCH WITH
HANDLES
WC (BATHROOM LOCK)
KEY LOCKING OPTION

SWING DOOR WITH JAMBS FOR ARCHITRAVES AND SWING DOOR WITH FLUSH JAMBS

SWING DOOR WITH JAMBS (see page L2)

SWING DOOR WITH FLUSH DOOR JAMBS (see page L7)

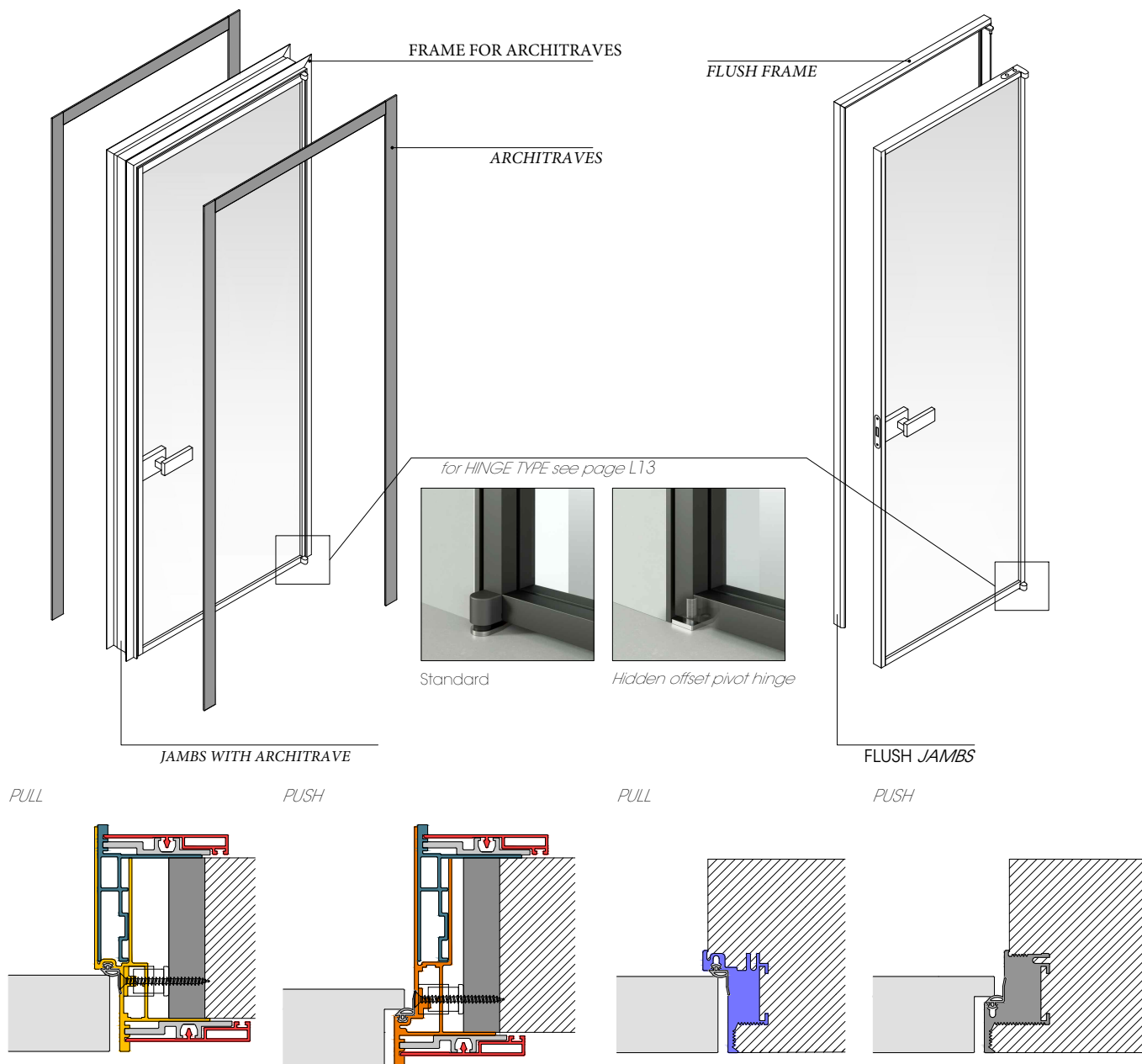

DOORS

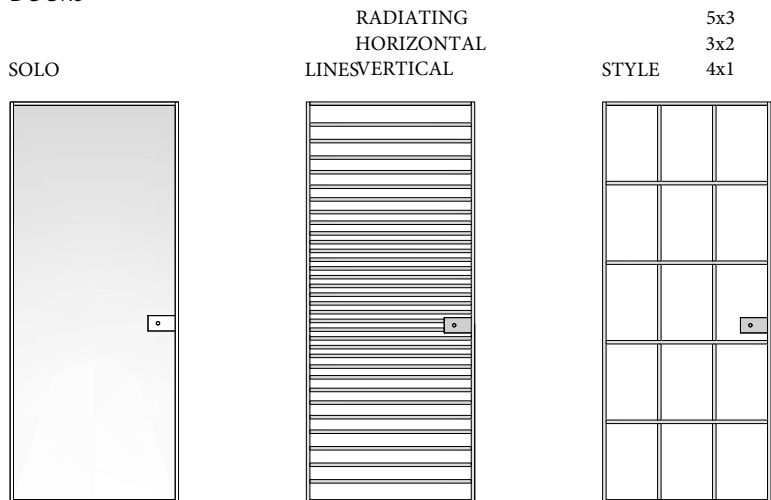

STYLE DOORS : BARS DESIGN IS CUSTOMISABLE

TECHNICAL FEATURES - JAMBS WITH ARCHITRAVES

ADJUSTMENT

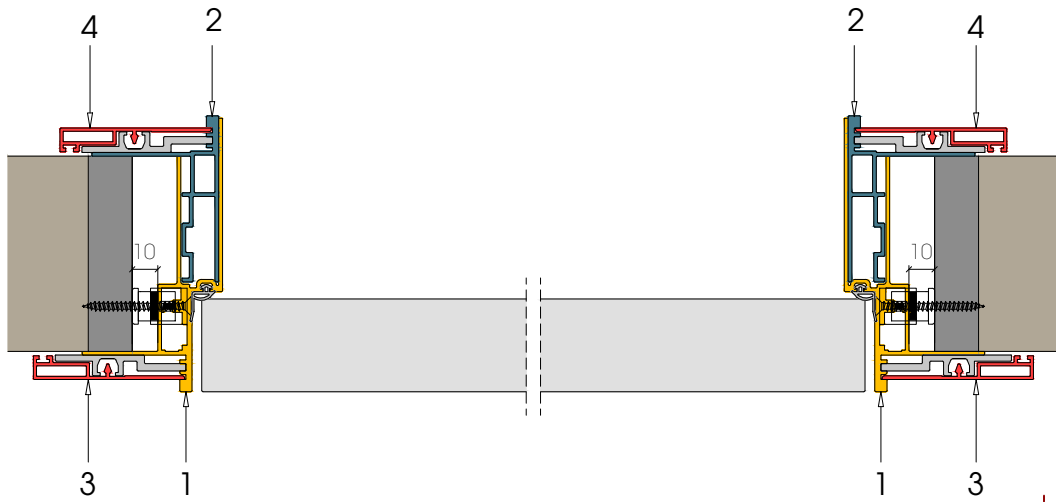

- 1) HINGED JAMB
- 2) TELESCOPIC JAMB
- 3) ARCHITRAVE FRONT SIDE
- 4) ARCHITRAVE REAR SIDE

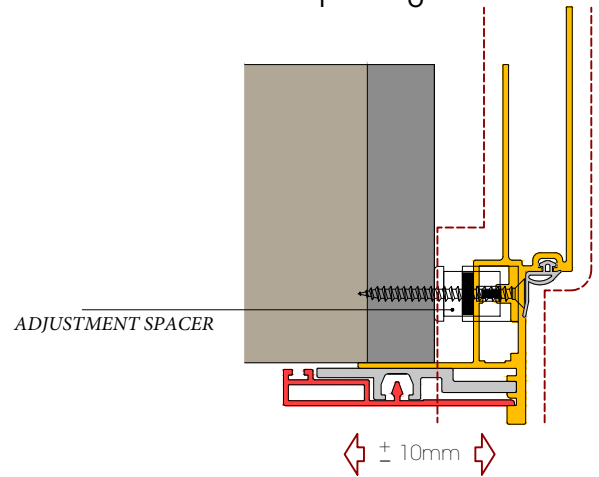

WALL THICKNESS COMPENSATION

MINIMUM wall thickness = 80 mm

PULL

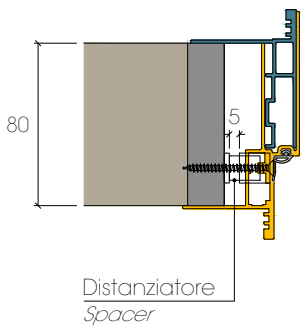

MAXIMUM wall thickness = 140 mm

PULL

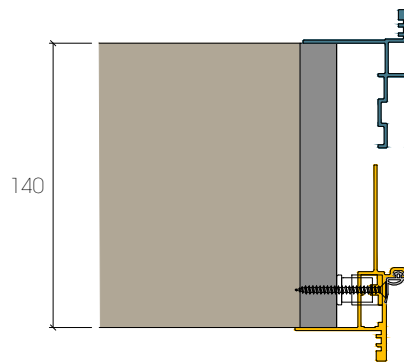

JAMB'S CUT

Wall thickness from 60mm to 80mm

PULL

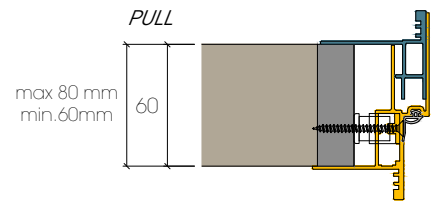

MINIMUM wall thickness = 87 mm

PUSH

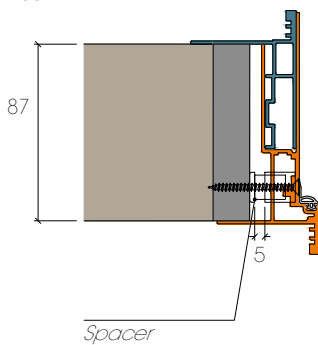

MAXIMUM wall thickness = 140 mm

PUSH

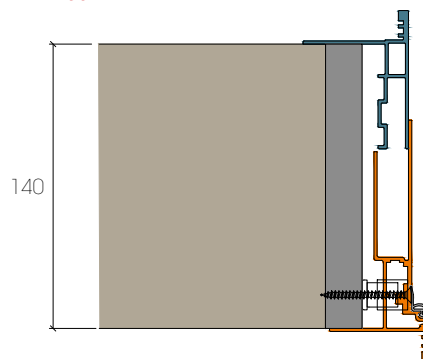

JAMB'S CUT

wall thickness = from 62 to 90 mm

PUSH

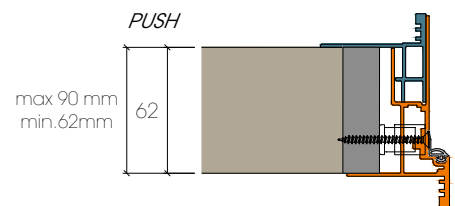

TECHNICAL FEATURES - JAMBS WITH ARCHITRAVES

ADJUSTMENT for wall thickness over 140 mm

PULL
Horizontal Section

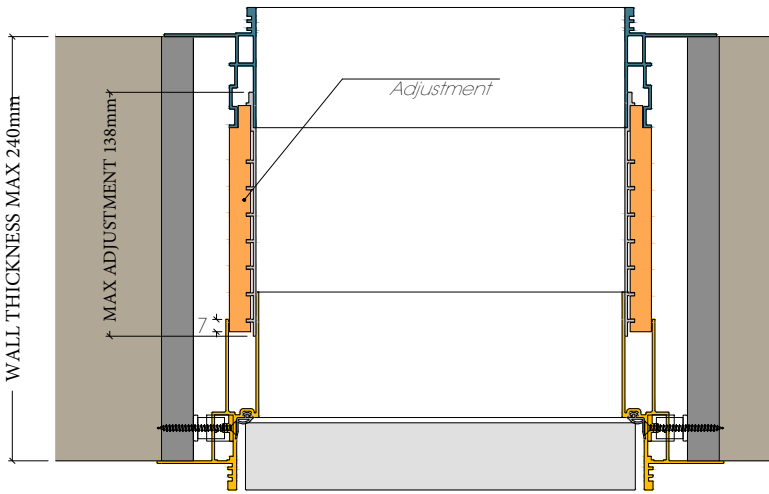

PULL
Vertical Section

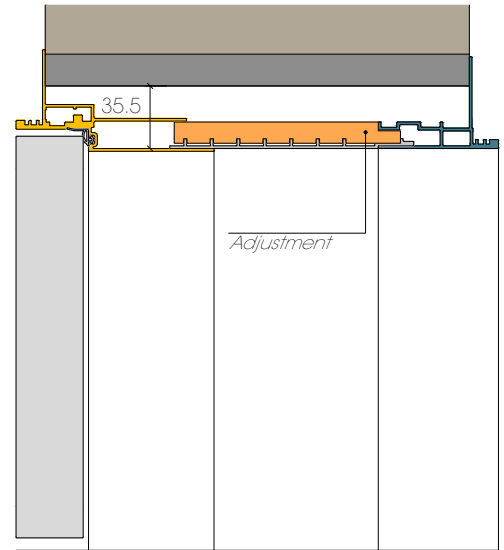

PUSH
HORIZONTAL
SECTION

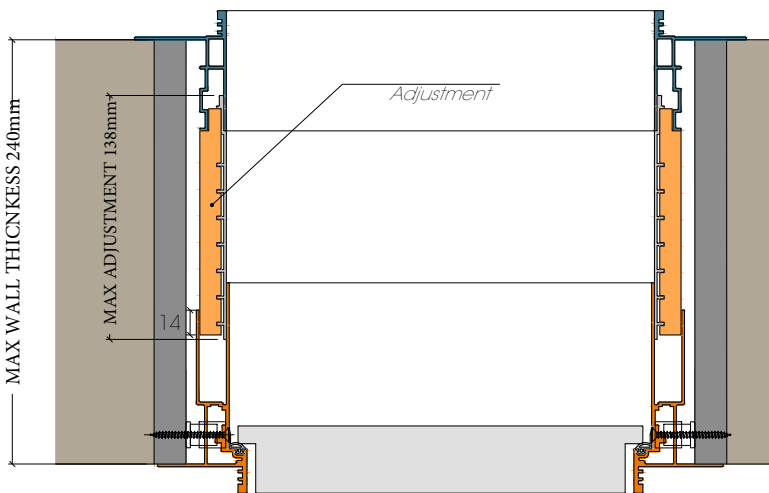

PUSH
VERTICAL SECTION

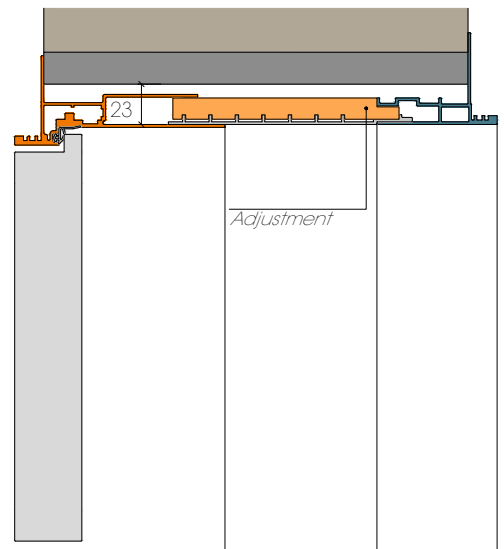

DIRECTIONS FOR ORDER: =
Specify the wall thickness

COVER PROFILES

SWING DOOR WITH JAMBS FOR ARCHITRAVES

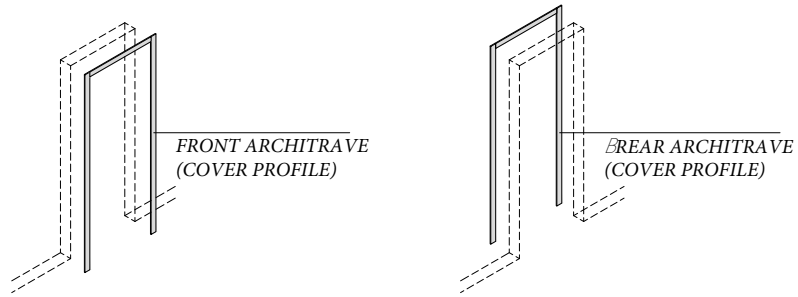

ALUMINUM COVER PROFILE



PULL

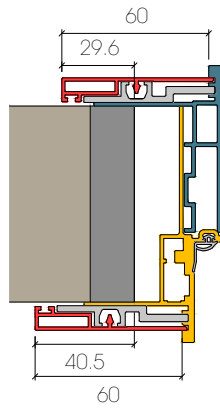

PUSH

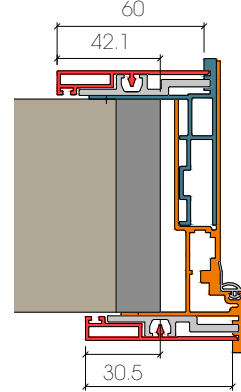

GLASS COVER PROFILE = FOR SOLO DOOR MODEL ONLY



PULL

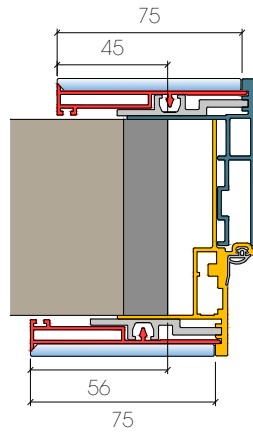

PUSH

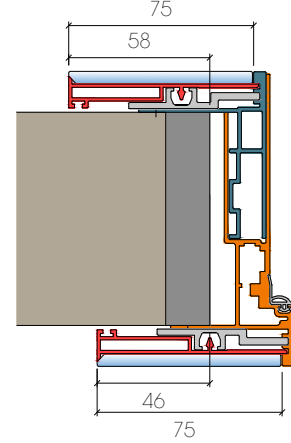

WITHOUT COVER PROFILE FOR CUSTOMIZED PANELING

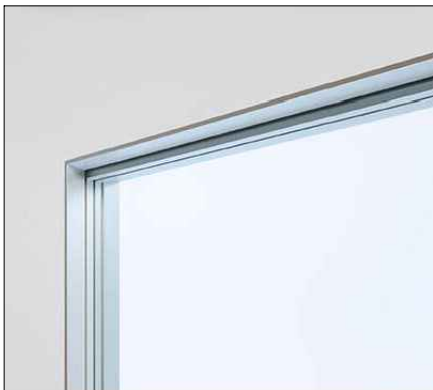

PULL

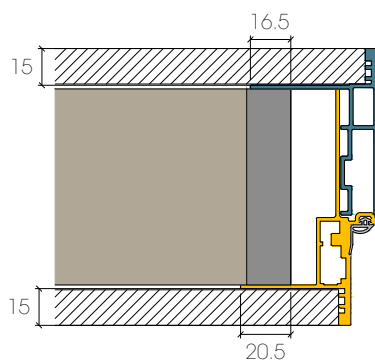

PUSH

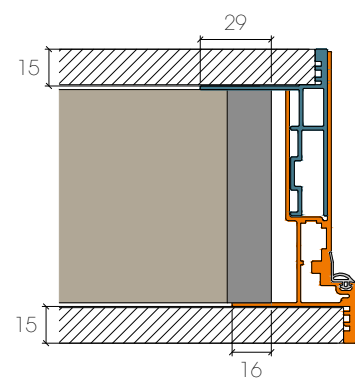

RULES - SWING DOOR WITH JAMBS FOR ARCHITRAVES

For PULL and PUSH DOORS specify the right or left opening side and the finishing side.

SX-PULL LEFT OPENING SIDE

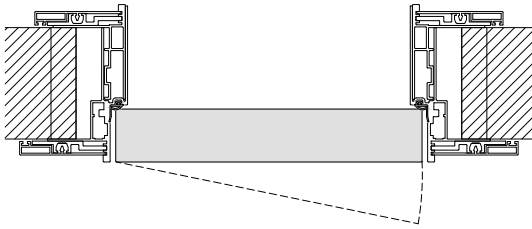

Opening at 180° - visible offset pivot hinge

Opening at 120° - hidden offset pivot hinge=
(vedi pag. L12 - see page L12)

DX-PULL RIGHT OPENING SIDE

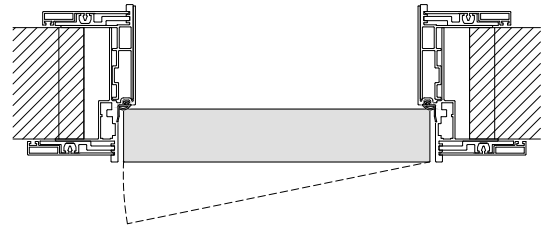

Opening at 180° - visible offset pivot hinge

Opening at 120° - hidden offset pivot hinge=
(vedi pag. L12 - see page L12)

SX-PUSH LEFT OPENING SIDE

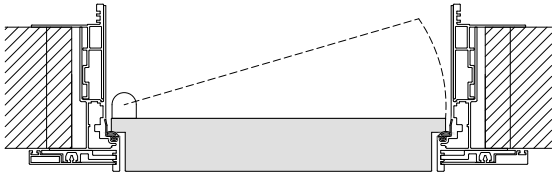

Opening at 90° - visible offset pivot hinge

DX-PUSH RIGHT OPENING SIDE

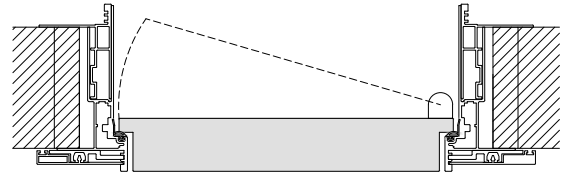

Opening at 90° - visible offset pivot hinge

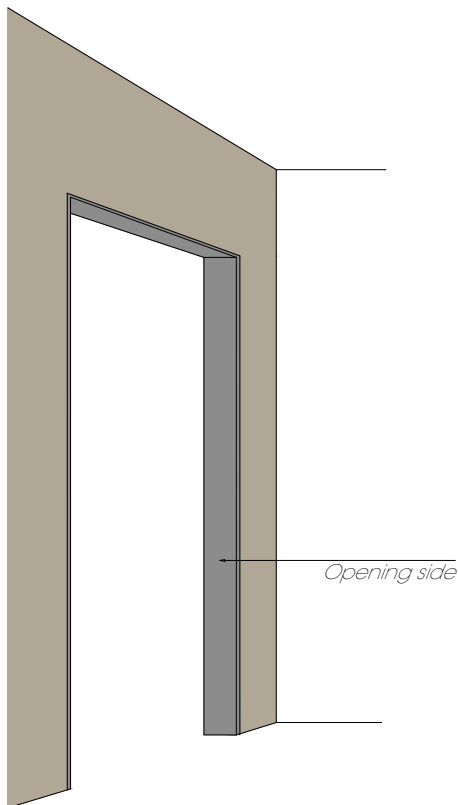

Opening side

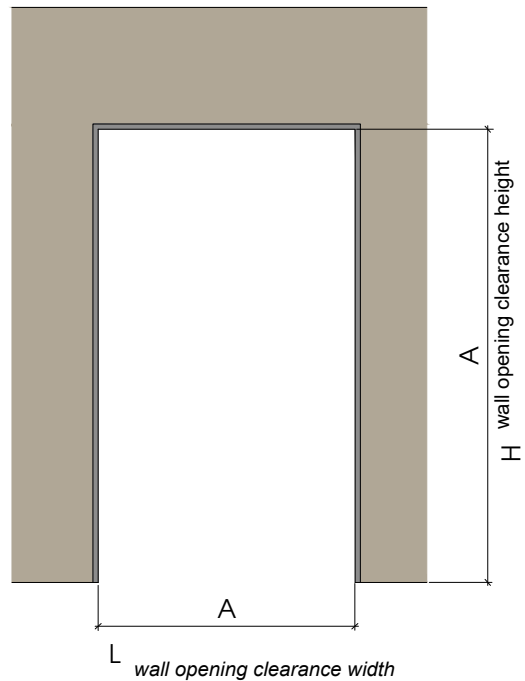

Wall thickness

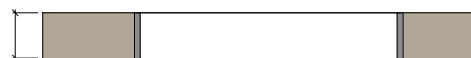

The jambs adjustment system allows for a tolerance in the wall opening size.

width	+10 mm
	-10 mm
height	+10 mm
	-10 mm

DOOR TO PULL RULES

SWING DOOR WITH JAMBS FOR ARCHITRAVES

SINGLE SWING DOOR / TO PULL

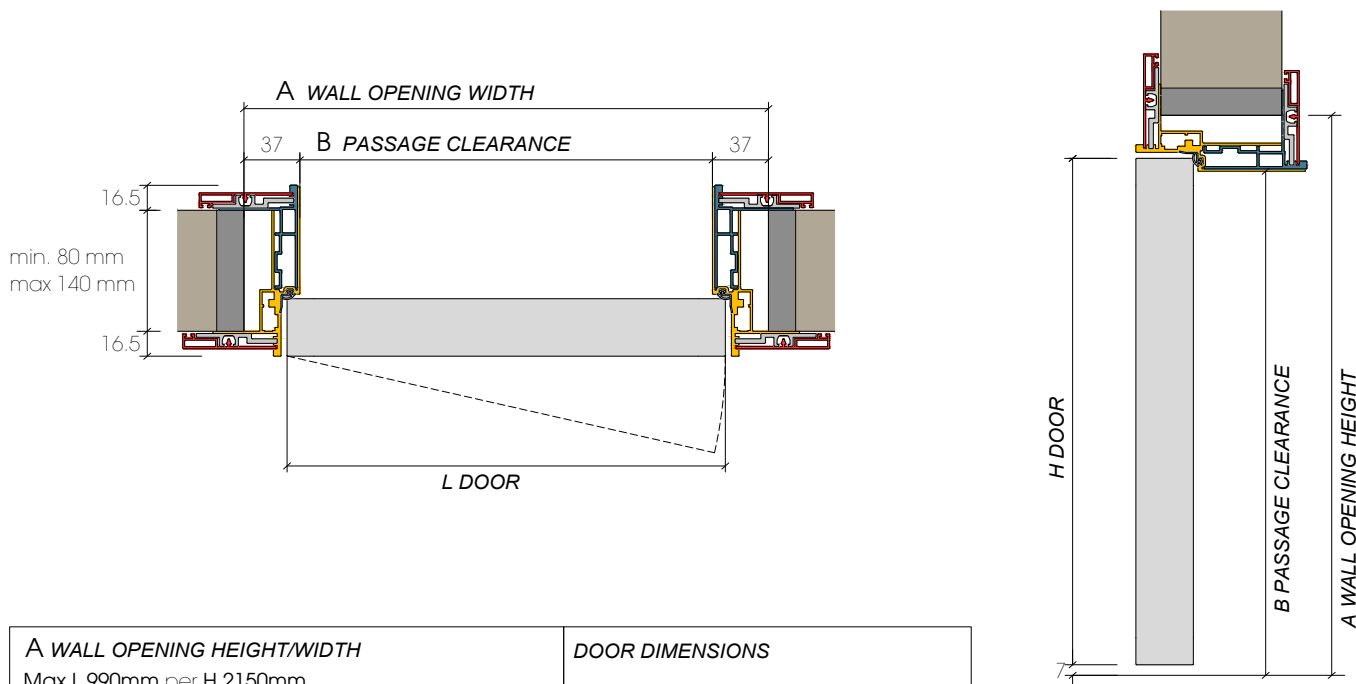

A WALL OPENING HEIGHT/WIDTH Max L 990mm per H 2150mm Max L 890mm per H 2650mm Max L 890mm per H 2900mm → SOLO	DOOR DIMENSIONS with Visible offset pivot hinge: $L_{DOOR} = A - 57mm$ $H_{DOOR} = A - 35.5mm$
B PASSAGE CLEARANCE $L_{PASSAGE CLEARANCE WIDTH} = A - 74mm$ $L_{PASSAGE CLEARANCE HEIGHT} = A - 37mm$	with Hidden offset pivot hinge: $L_{DOOR} = A - 59mm$ $H_{DOOR} = A - 36.5mm$

DOUBLE SWING DOOR / TO PULL

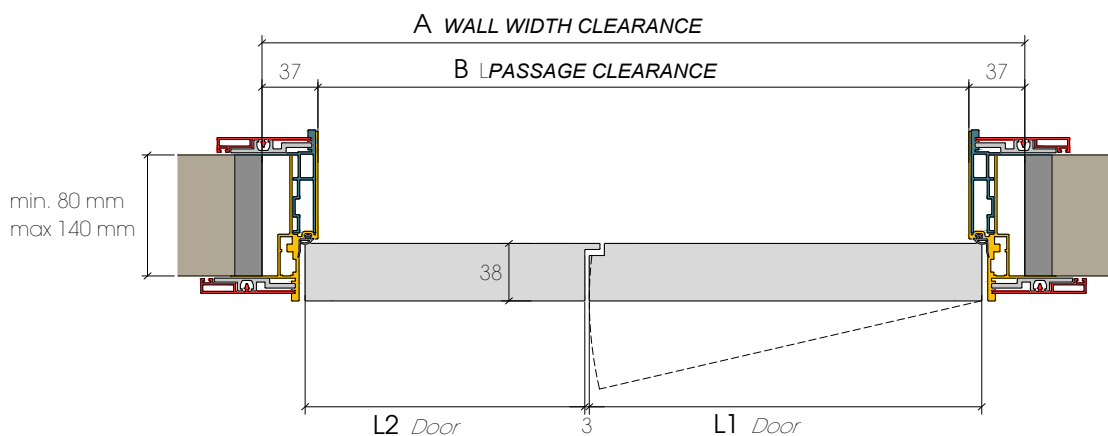

A WALL OPENING HEIGHT/WIDTH	DOOR DIMENSIONS			
	L1	L2	H max SOLO	H max OTHERS
min L 990mm	633	297	2900	2650
min L 1190mm	833	297	2900	2650
min L 1726mm	833	833	2900	2650
max L 1926mm	933	933	2150	2150
B PASSAGE CLEARANCE $L_{PASSAGE CLEARANCE WIDTH} = A - 74mm$ $L_{PASSAGE CLEARANCE HEIGHT} = A - 37mm$	with Visible offset pivot hinge: $L_{EQUAL DOORS} = (A : 2) - 30mm$ $H_{DOOR} = A - 35.5mm$ with Hidden offset pivot hinge: $L_{EQUAL DOORS} = (A : 2) - 31mm$ $H_{DOOR} = A - 36.5mm$			

DOOR TO PUSH RULES

SWING DOOR WITH JAMBS FOR ARCHITRAVES

SINGLE SWING DOOR | TO PUSH

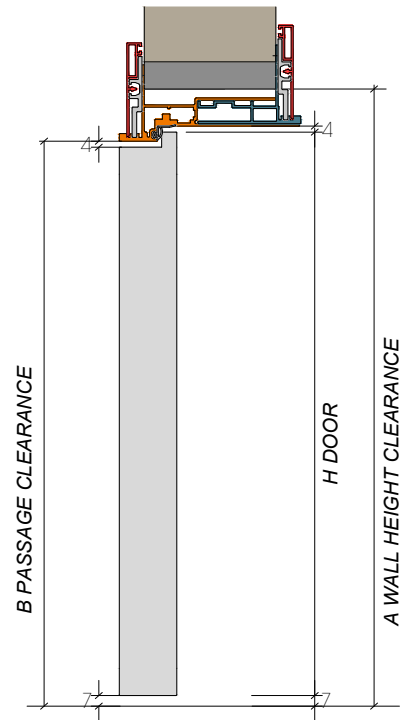
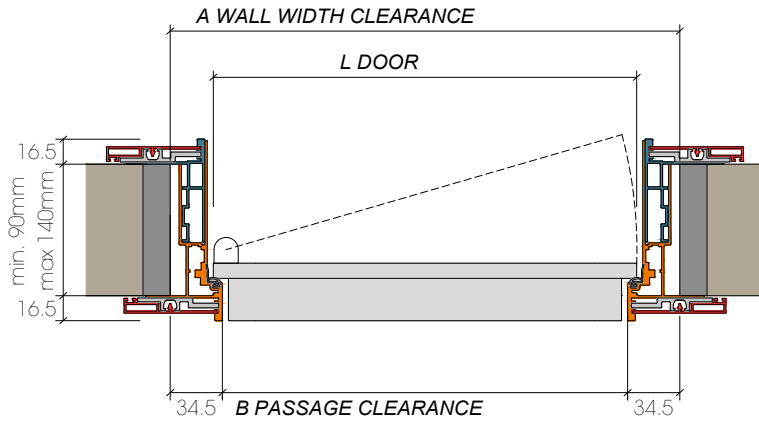

A WALL CLEARANCE	
Max L 990mm per H 2150mm	
Max L 890mm per H 2650mm	
Max L 890mm per H 2900mm → SOLO	
B PASSAGE CLEARANCE	
L PASSAGE CLEARANCE = A - 69mm	
H PASSAGE CLEARANCE = A 34.5mm	
DOOR DIMENSIONS=	
:	
L DOOR = A - 57mm	
H DOOR = A - 35.5mm	

DOUBLE SWING DOOR | TO PUSH

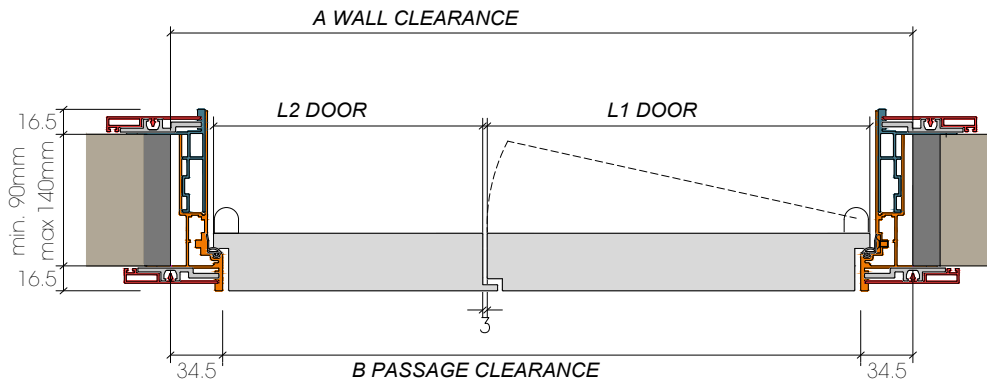

A WALL CLEARANCE					B PASSAGE CLEARANCE	
	L1	L2	H max SOLO	H max OTHERS	L PASSAGE CLEARANCE = A - 69mm	
min L 990mm	633	297	2900	2650	H PASSAGE CLEARANCE = A - 34.5mm	
min L 1190mm	833	297	2900	2650	DOOR DIMENSIONS	
min L 1726mm	833	833	2900	2650	only Visible offset pivot hinge:	
max L 1926mm	933	933	2150	2150	L EQUAL DOORS = (A : 2) - 30mm	
					H DOOR = A - 35.5mm	

HINGES - SWING DOORS - TECHNICAL FEATURES

STANDARD: VISIBLE OFFSET PIVOT HINGE

PULL OPENING

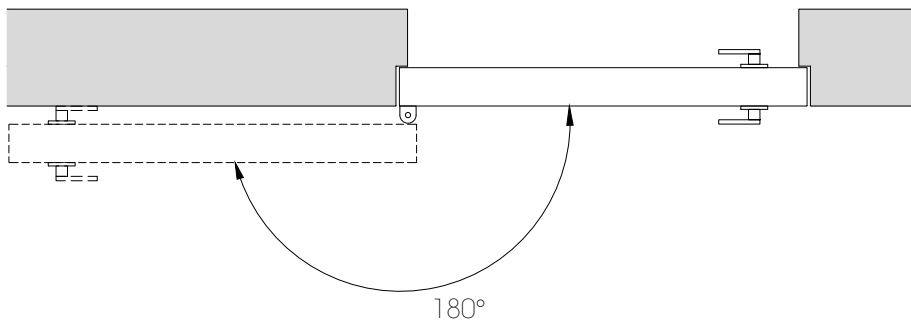

PUSH OPENING

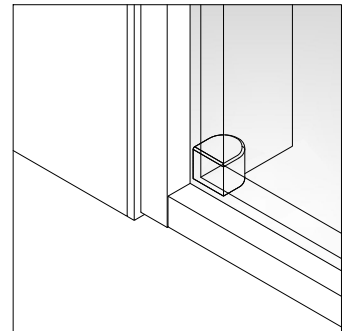
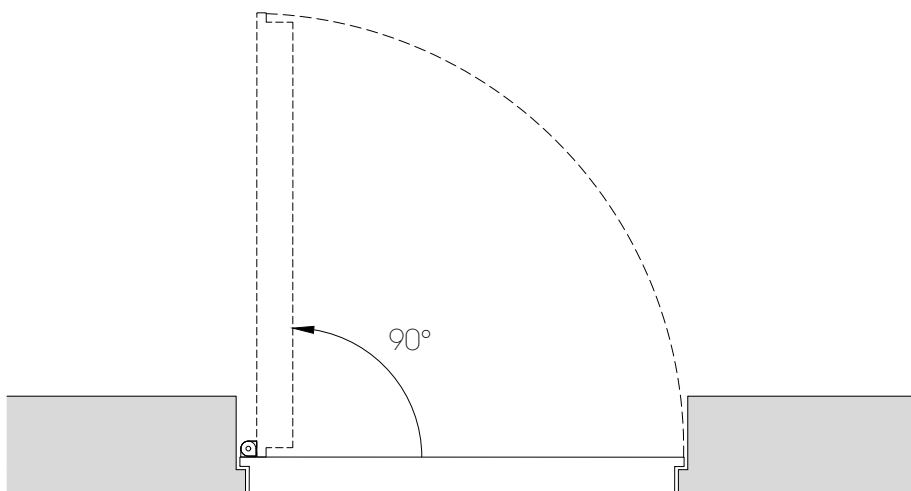

HINGE REGULATION

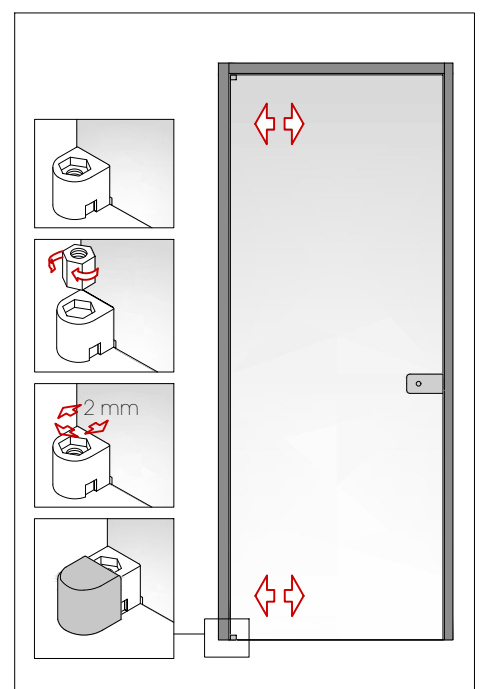

DETAIL: UPPER HINGE PULL OPENING

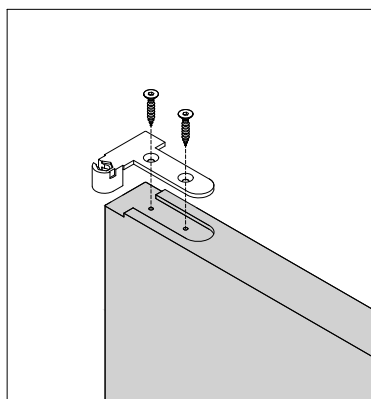

DETAIL: UPPER HINGE PUSH OPENING

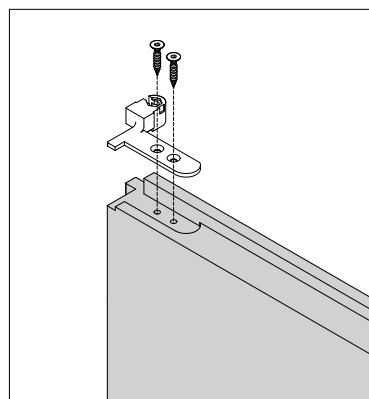

HINGES - SWING DOORS - TECHNICAL FEATURES

HIDDEN OFFSET PIVOT HINGE: ON DEMAND

ONLY PULL OPENING

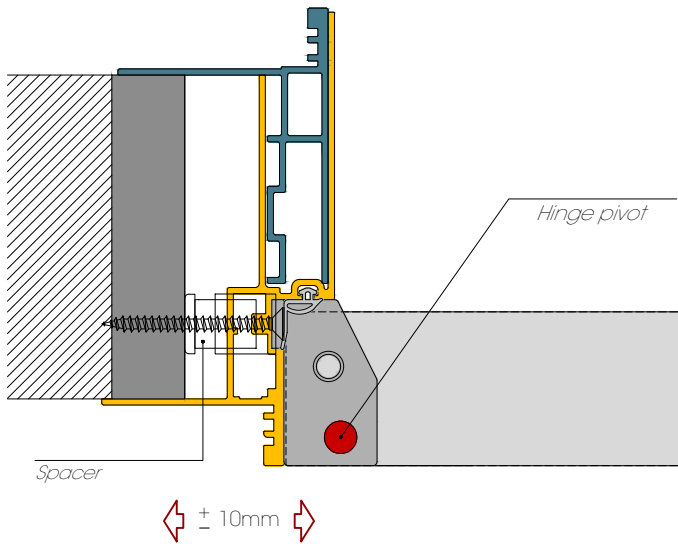
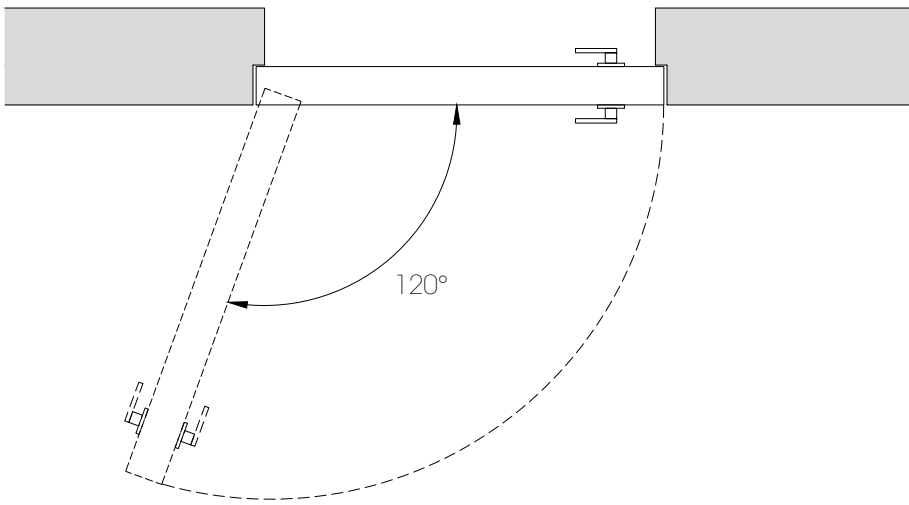

THE ADJUSTMENT OF THE HINGE (DOOR)

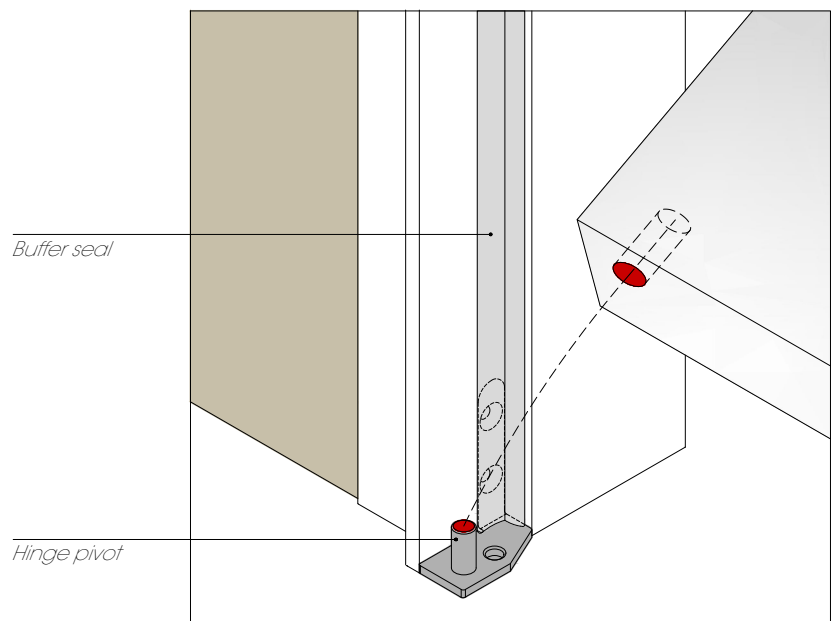

SOLO - Swing door

WITH JAMBS FOR ARCHITRAVES

WITH FLUSH JAMBS

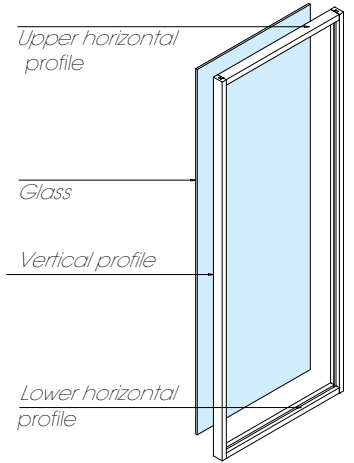
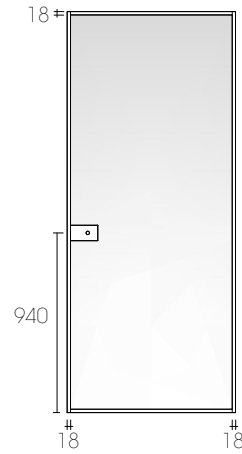

SECTION DOOR PULL

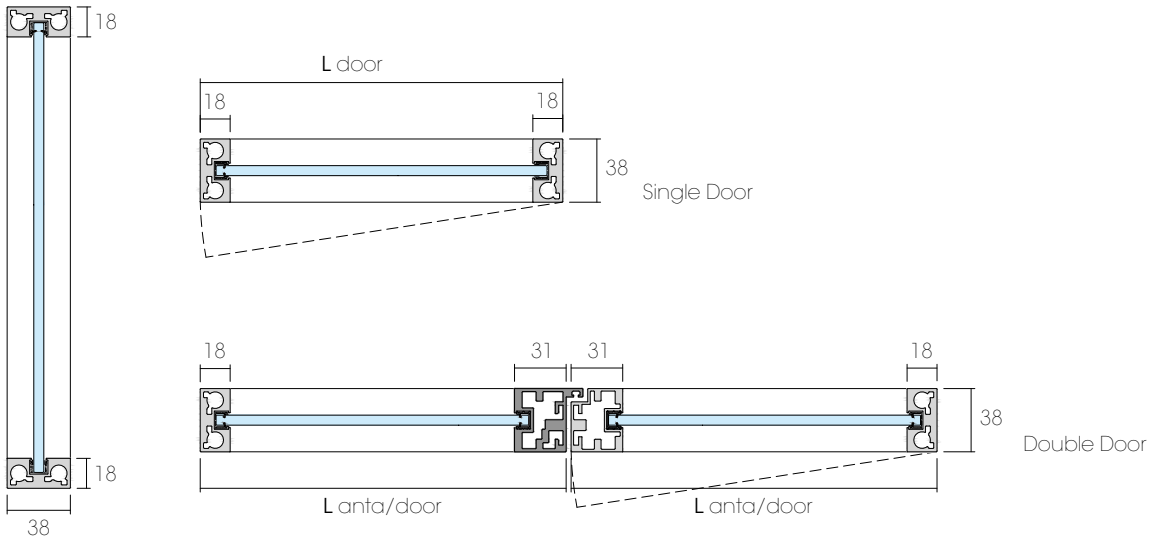

SECTION DOOR PUSH

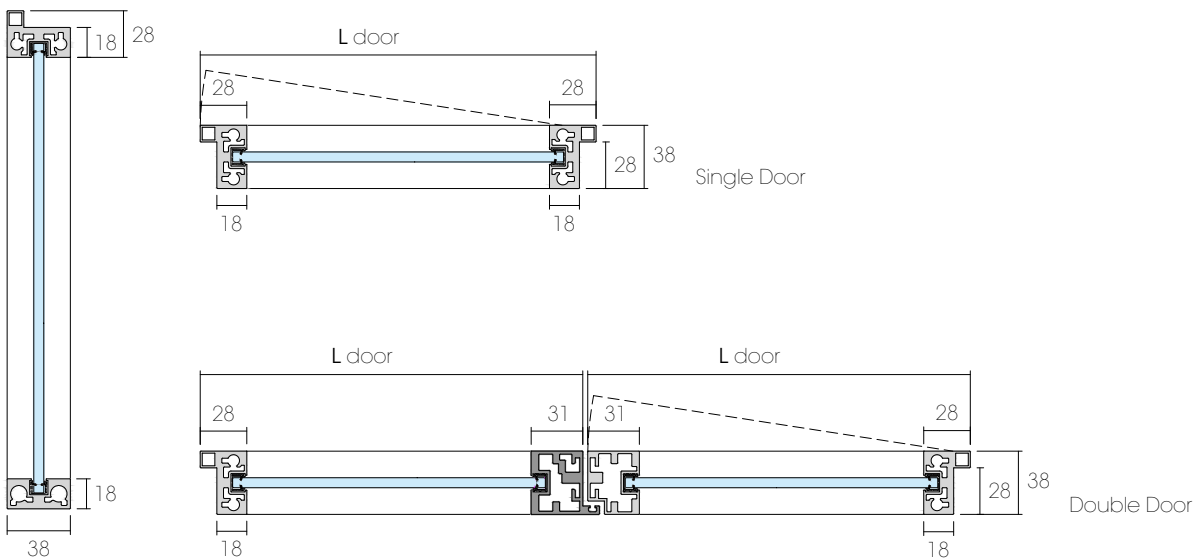

Swing door - 5 x 3, 3 x 2, 4 x 1 - customisable bar design

WITH JAMBS FOR ARCHITRAVES



WITH FLUSH JAMBS



STYLE 5 X 3

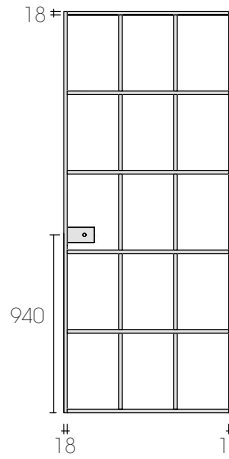

STYLE 3 X 2

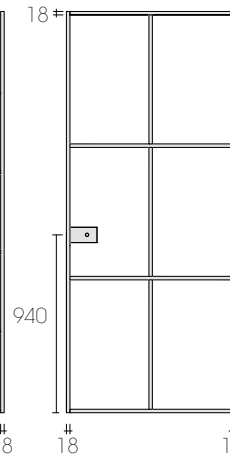

STYLE 4 X 1

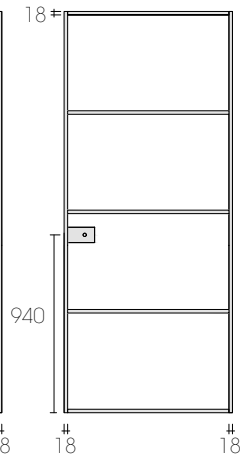

SECTION DOOR PULL

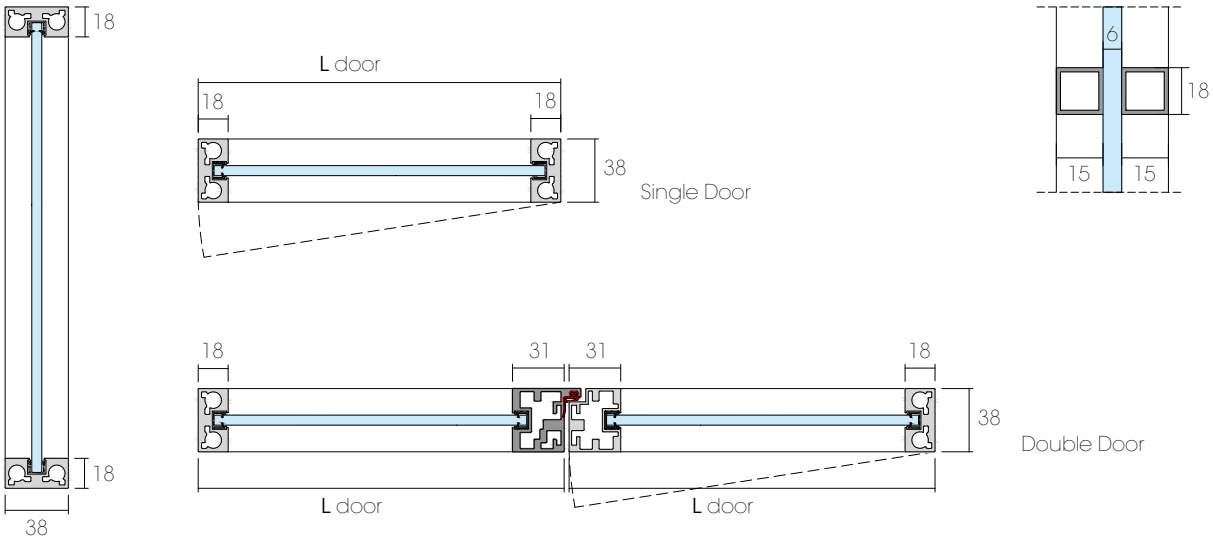

SECTION DOOR PUSH

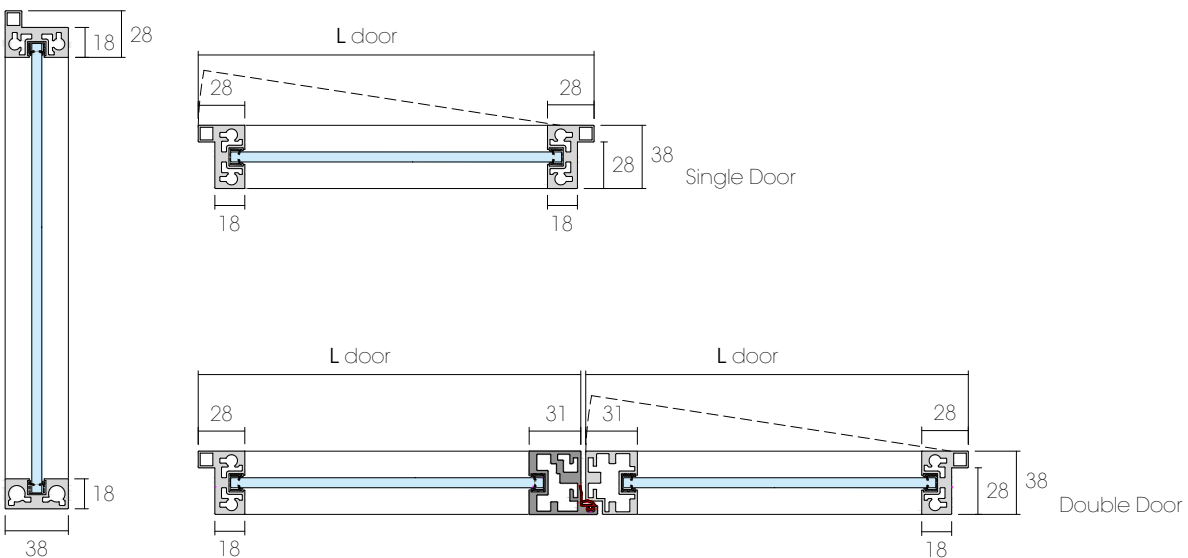

LINE - Swing door

WITH JAMBS FOR ARCHITRAVES

WITH FLUSH JAMBS

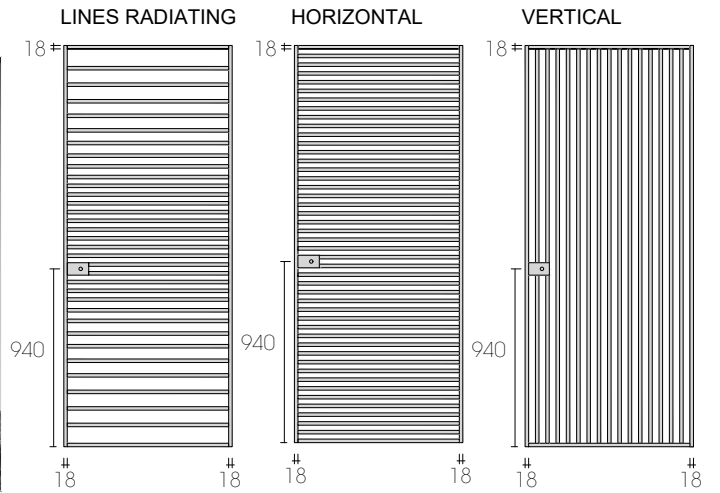

SECTION DOOR PULL

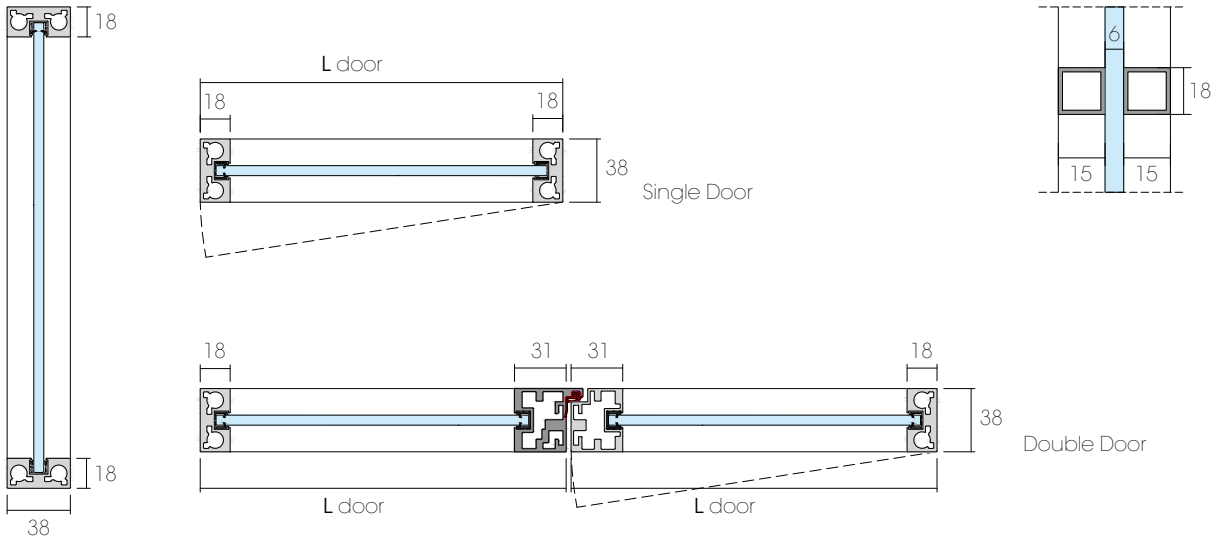

SECTION DOOR PUSH

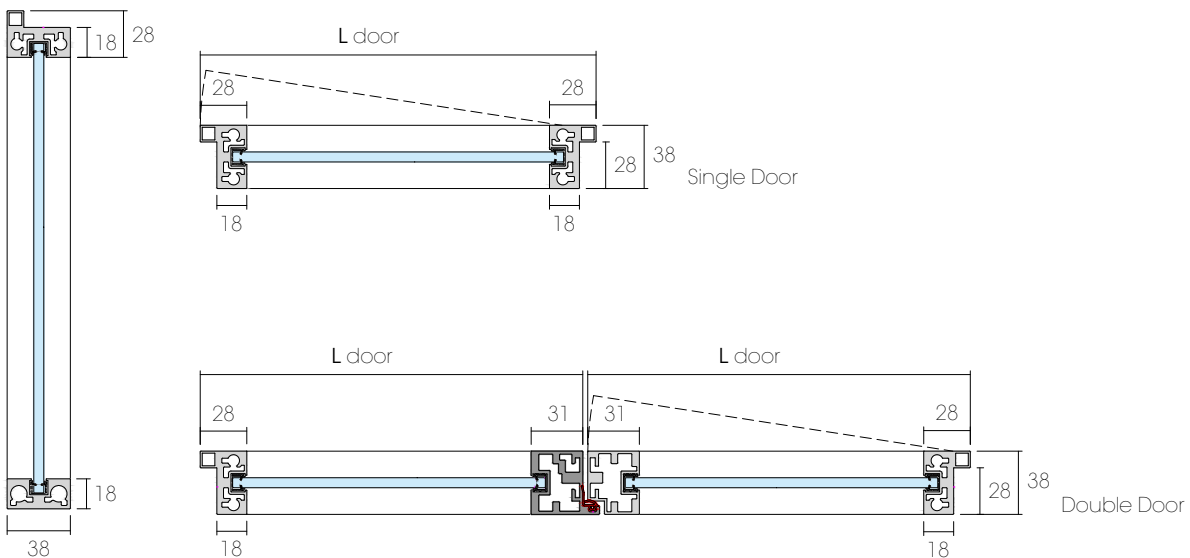

Swing door - DOORS LOCK

MAGNETIC LOCK

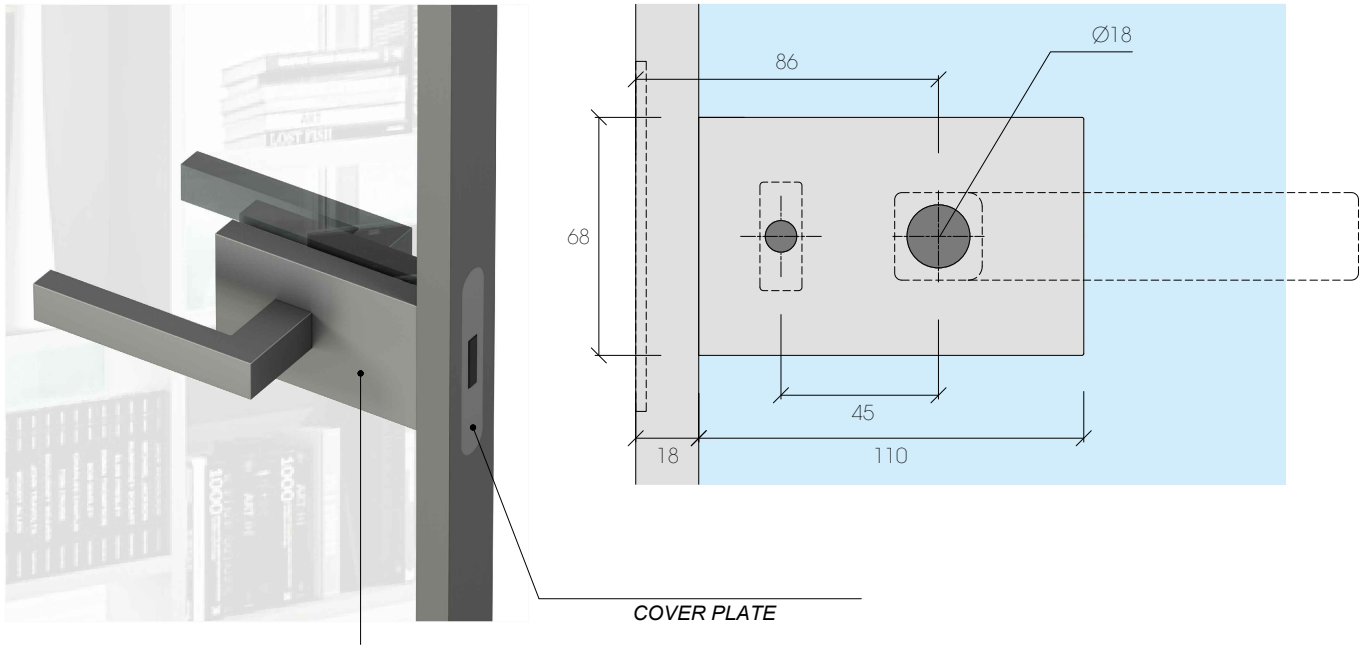

HANDLE, LOCK AND COVER PLATE

Matt lacquered same finish like's door frame

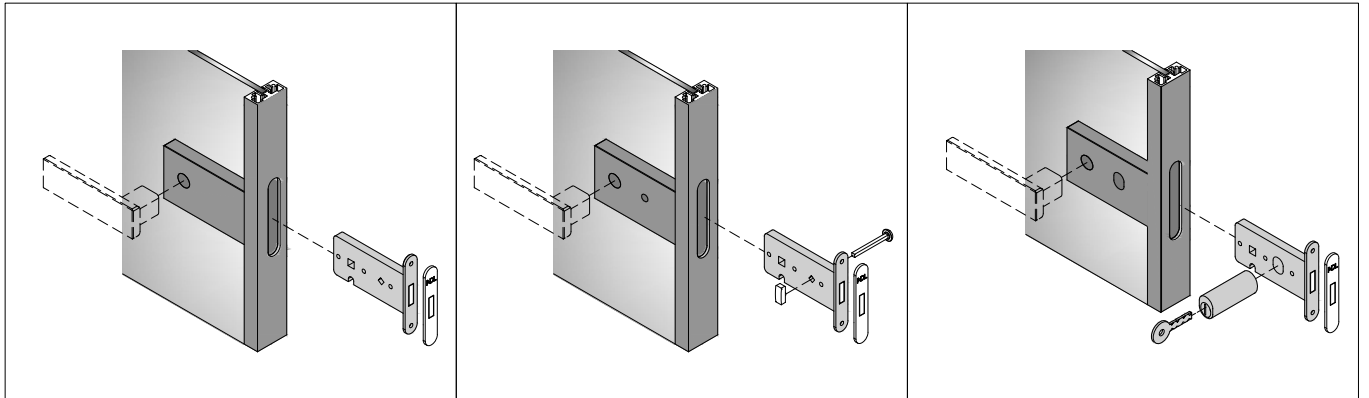

MAGNETIC LOCK
FOR HANDLE ONLY

MAGNETIC LOCK=WITH
LATCH (WC)

MAGNETIC LOCK
WITH SECURITY CYLINDER/FLAT KEY

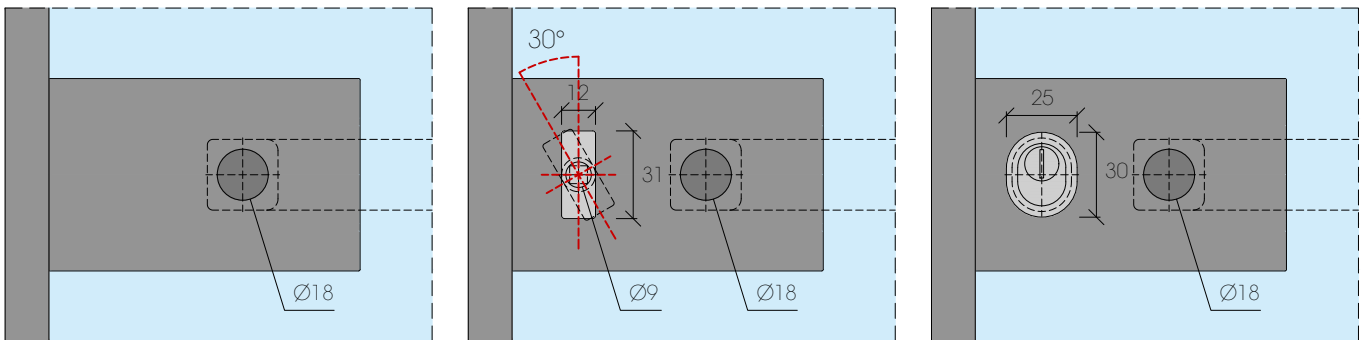

ROTATION FOR CLOSING OF 30°

LINE door lock

LINE RADIATING

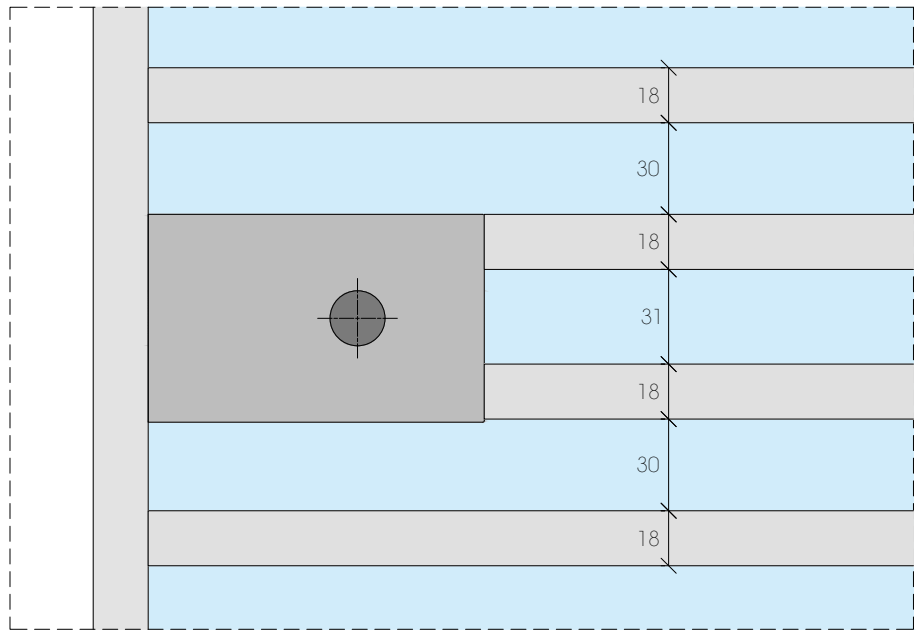
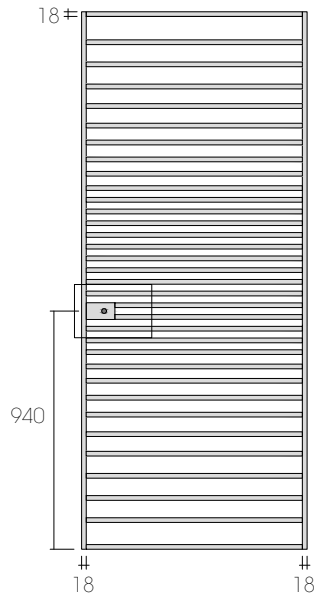

LINE HORIZONTAL

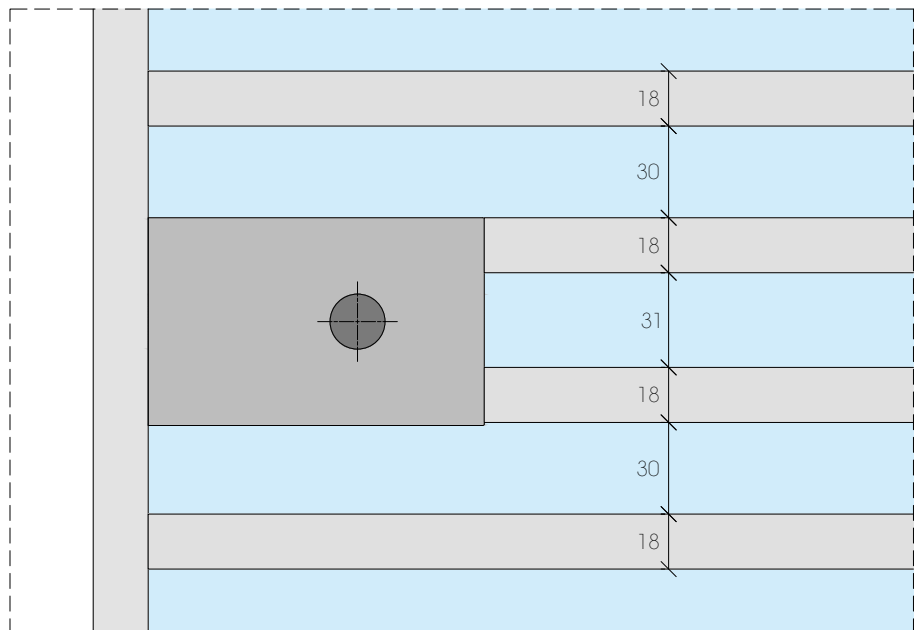
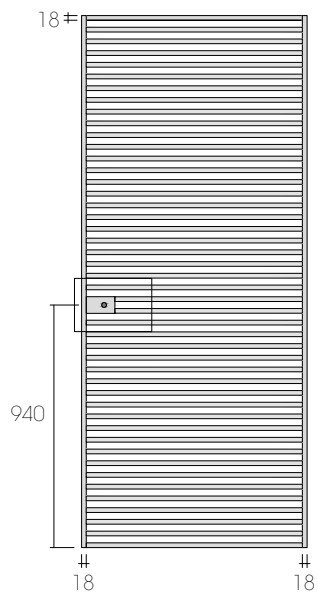

LINE VERTICAL

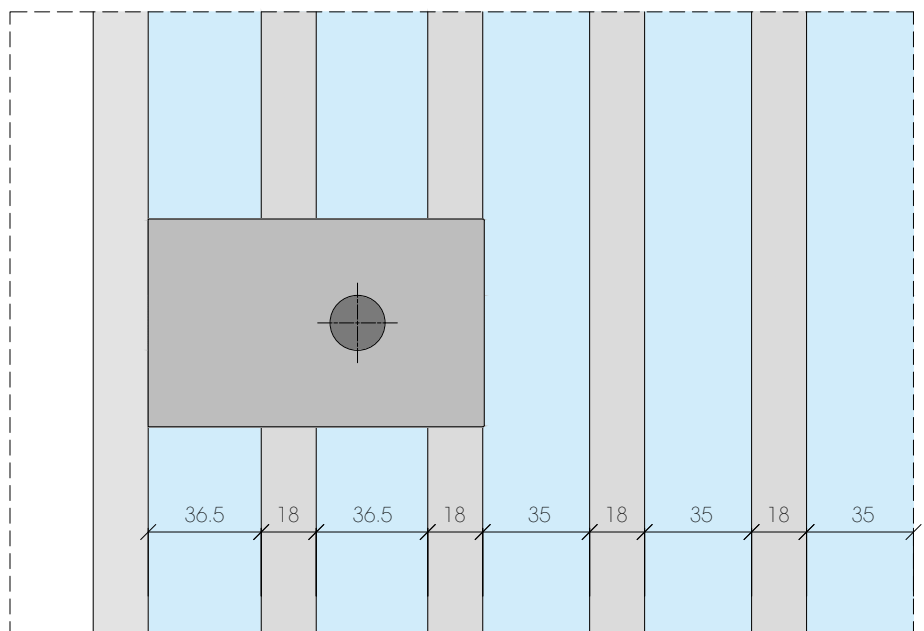
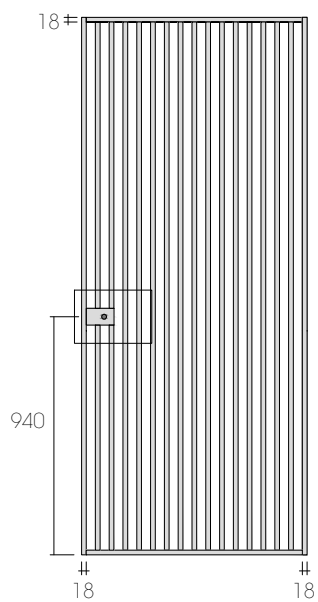

FLUSH WITH THE WALL FRAMES

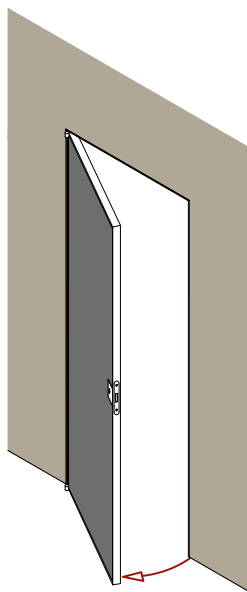

FLUSH WITH THE WALL FRAME
FLUSH ON THE PULL SIDE

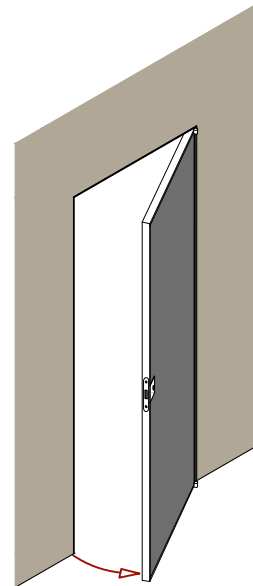
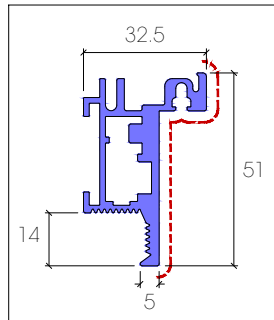

PROTECTION FILM
jamb is always anodized and therefore it should
NEVER BE TREATED WITH WALL PAINTING

SX-PULL LEFT OPENING SIDE

DX-PULL RIGHT OPENING SIDE

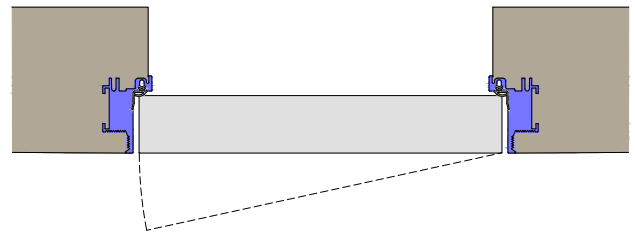
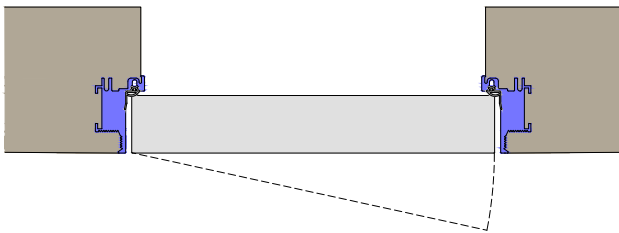

Opening at 180° - visible offset pivot hinge

Opening at 180° - visible offset pivot hinge

Opening at 120° - hidden offset pivot hinge

Opening at 120° - hidden offset pivot hinge

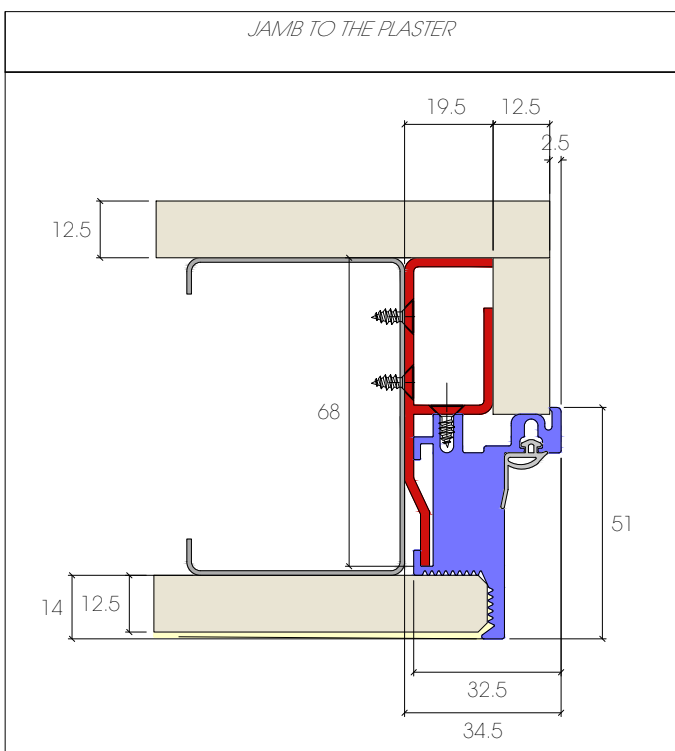

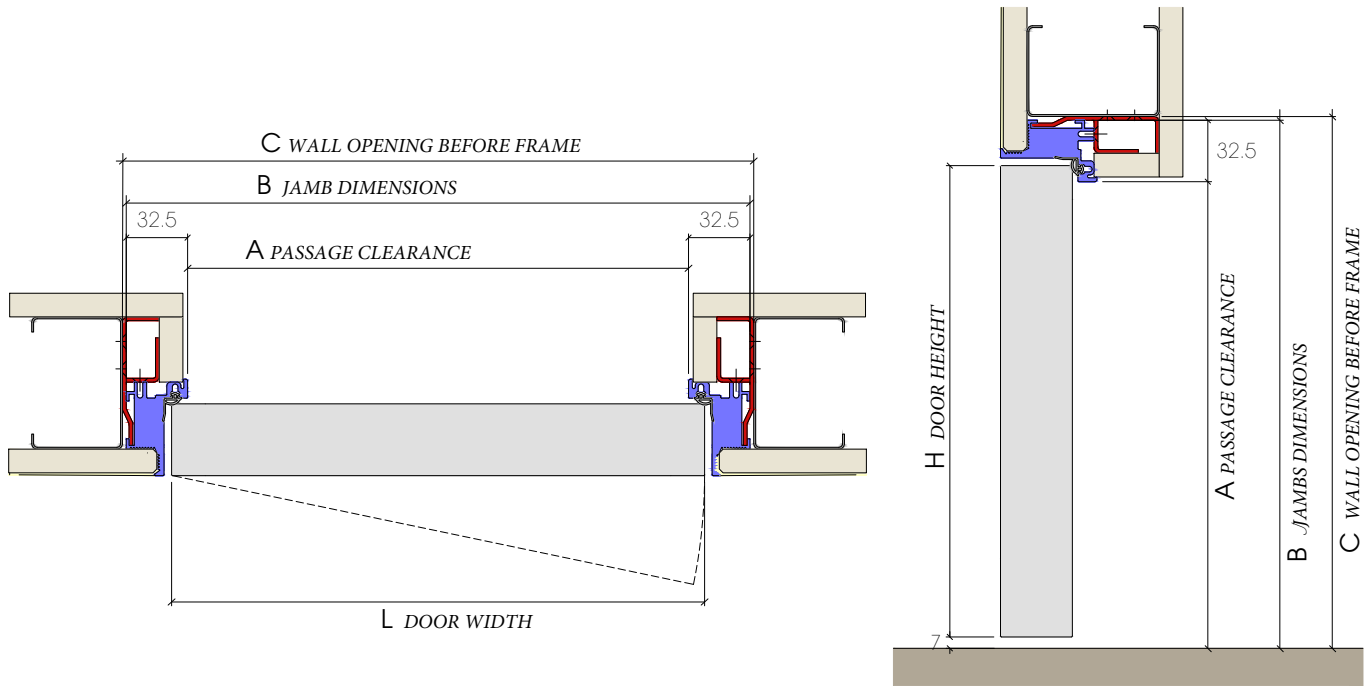

<p>DOOR DIMENSIONS MAX Max L 933mm per H 2115mm Max L 833mm per H 2615mm Max L 833mm per H 2865mm → SOLO</p>	<p>C WALL OPENING BEFORE FRAME WIDTH A + 70mm circa HEIGHT A + 35mm circa</p>	<p>DOOR DIMENSIONS with Visible offset pivot hinge: L Door = A + 17mm H Door = A + 1.5mm with Hidden offset pivot hinge: L Door = A + 15mm H Door = A + 0.5mm</p>
<p>A PASSAGE CLEARANCE</p>		
<p>B JAMBS DIMENSIONS L Jamb = A + 65mm H Jamb = A + 32.5mm</p>		

PLASTER APPLICATION

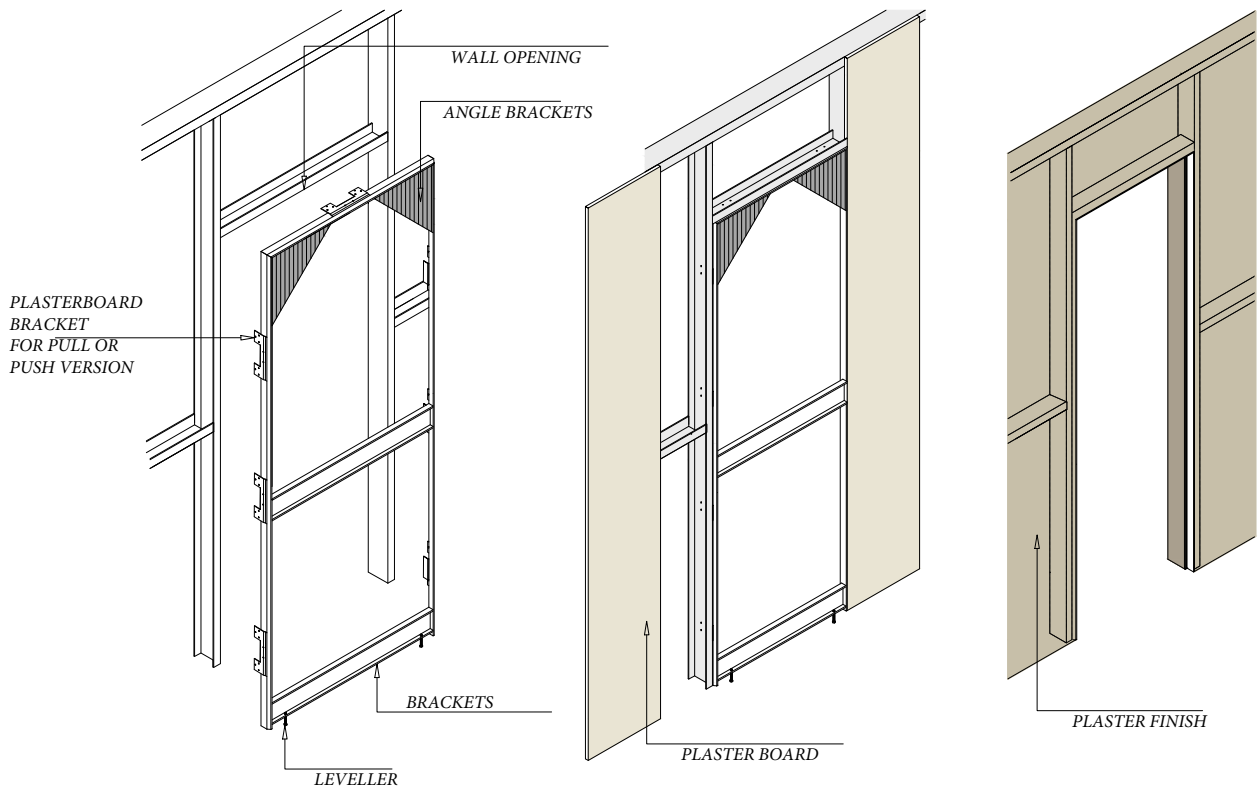

FLUSH WITH THE WALL FRAME
FLUSH ON THE PUSH SIDE

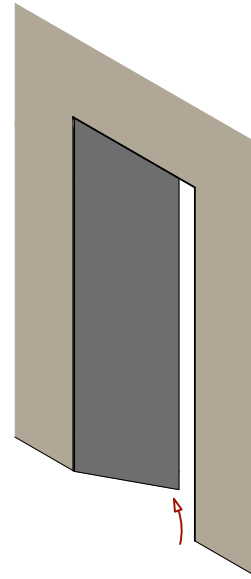
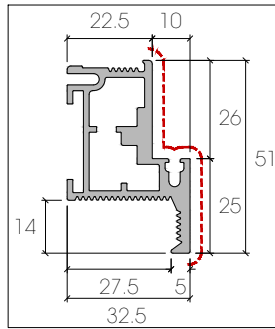
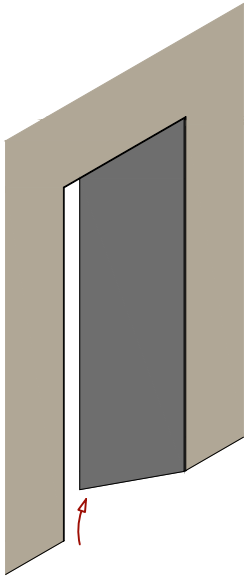

PROTECTION FILM
jamb is always anodized and therefore it should
NEVER BE TREATED WITH WALL PAINTING

SX-PUSH LEFT OPENING SIDE

DX-PUSH RIGHT OPENING SIDE

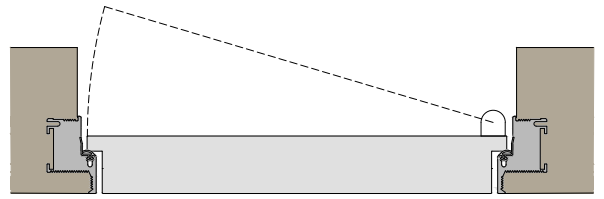
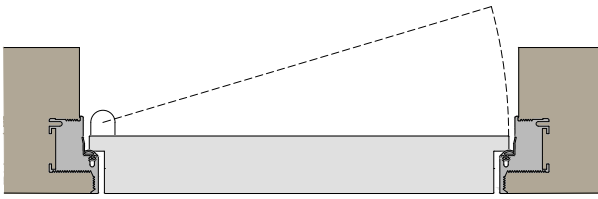

Opening at 90° - visible offset pivot hinge

Opening at 90° - visible offset pivot hinge

JAMB TO THE PLASTER

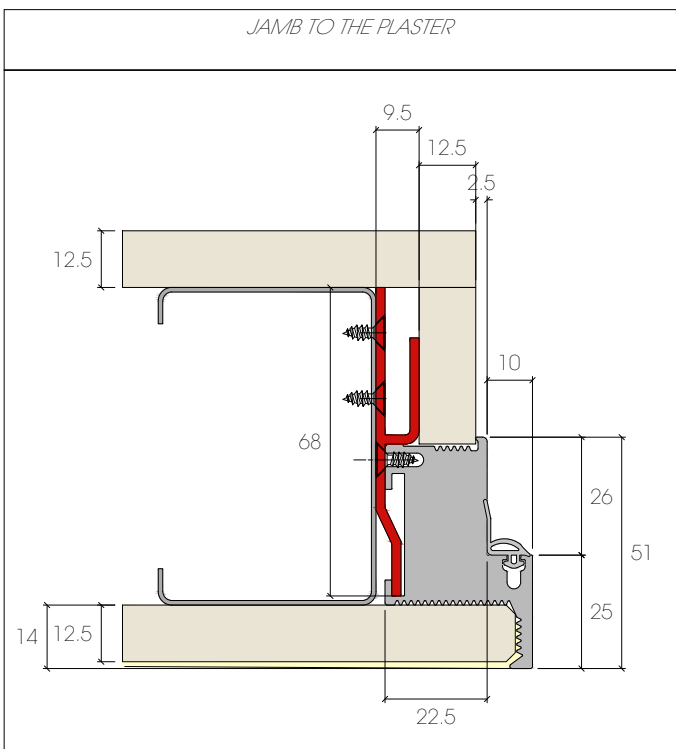

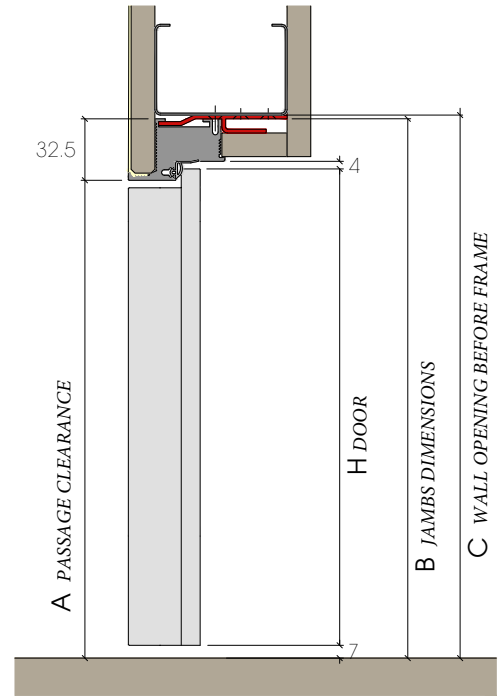
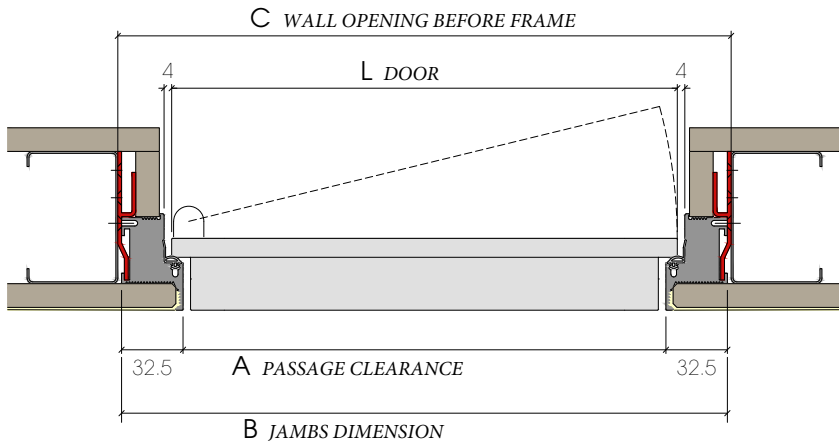

<p>DOOR DIMENSIONS MAX Max L 933mm per H 2115mm Max L 833mm per H 2615mm Max L 833mm per H 2865mm → SOLO</p>	<p>C WALL OPENING BEFORE FRAME L WIDTH A + 70mm circa H HEIGHT A + 35mm circa</p>	<p>DOOR DIMENSIONS <i>only Visible offset pivot hinge:</i></p>
<p>A PASSAGE CLEARANCE</p>		<p>L DOOR = A + 12mm H DOOR = A - 1mm</p>
<p>B JAMBS DIMENSIONS L JAMB WIDTH = A + 65mm H JAMB HEIGHT = A + 32.5mm</p>		

PLASTER APPLICATION

