

LEVANTE - *Sliding Screens*

DOORS WITH FIXED LOUVRES - WITHOUT GLASS

TWO APPLICATIONS:

INDOOR

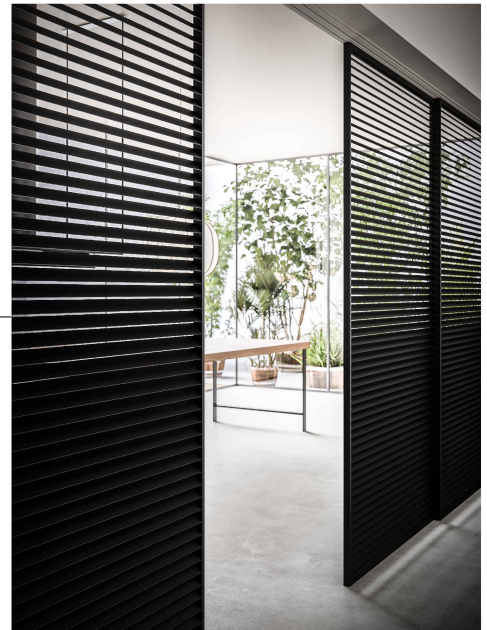

OUTDOOR

NOT for WOOD finishings

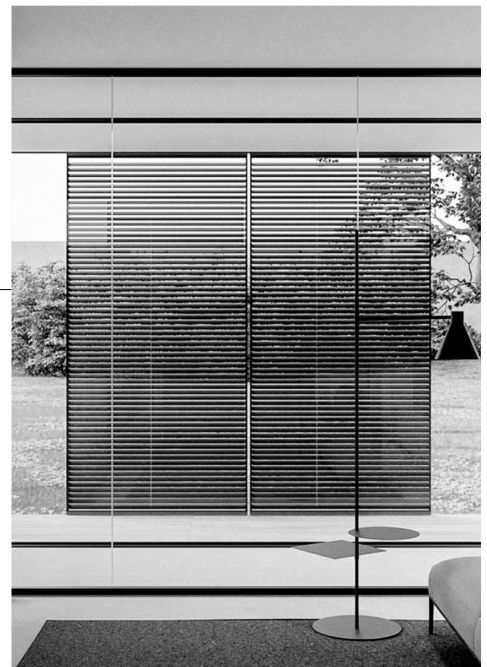

The sliding door is suitable for the outdoor use, also in its "free movement" configuration, as a privacy or sun screen. It must be sheltered by at least 50cm as in the example.

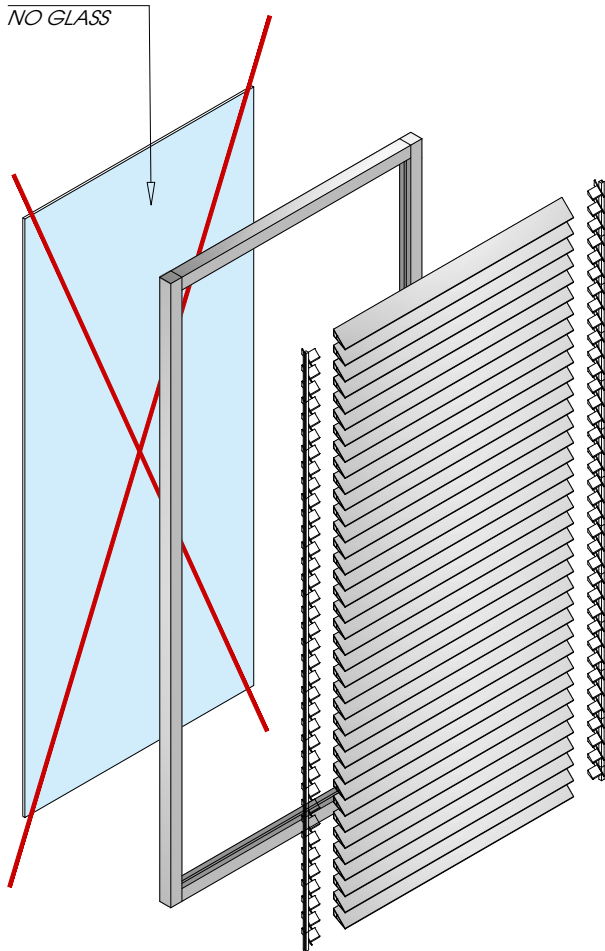

The doors and rails must be set back by at least 50cm

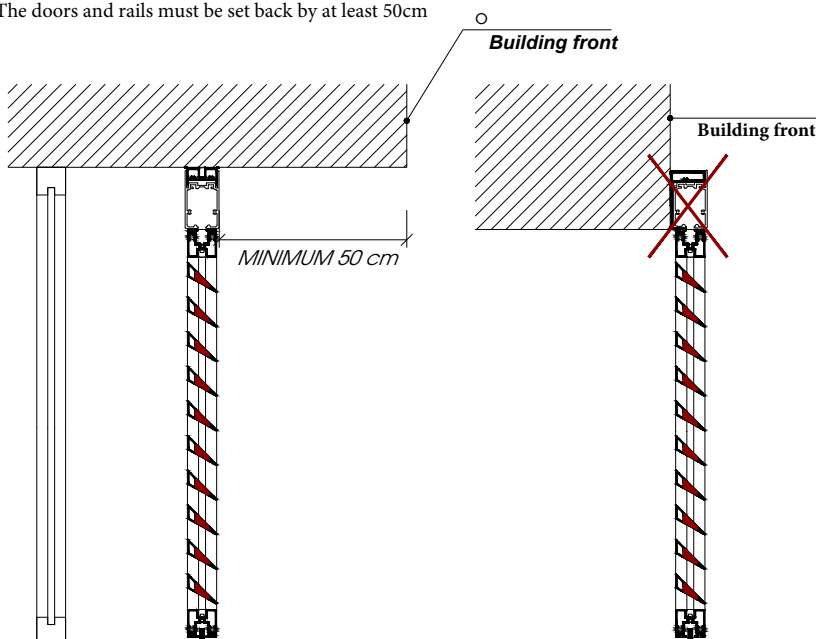

LEVANTE *Sliding Screens*

TWO SLIDING SYSTEMS:

SLIDING

With *lower guide*

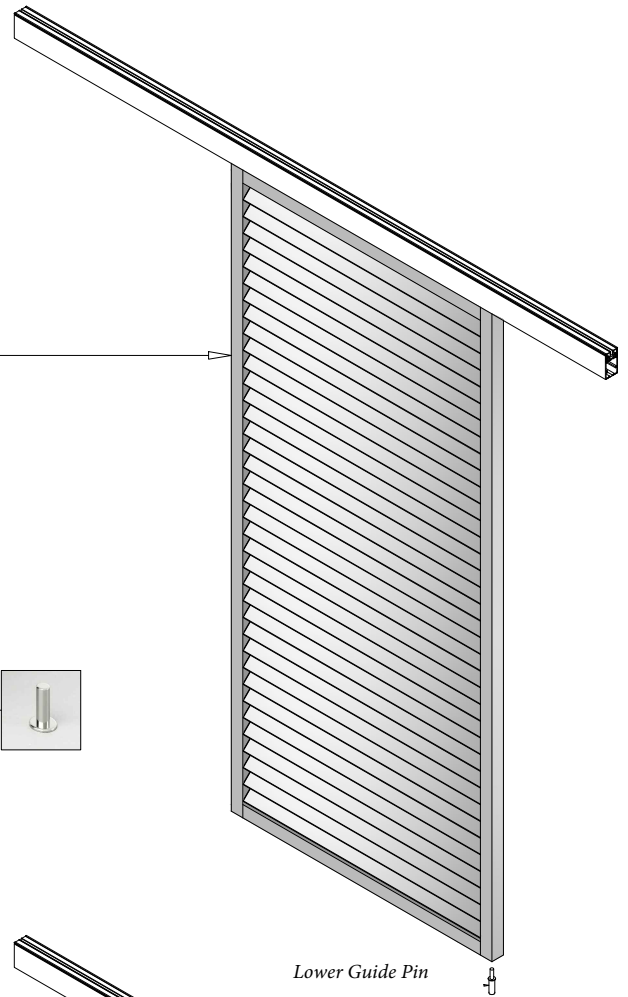

Free Movement
With floor guide rail

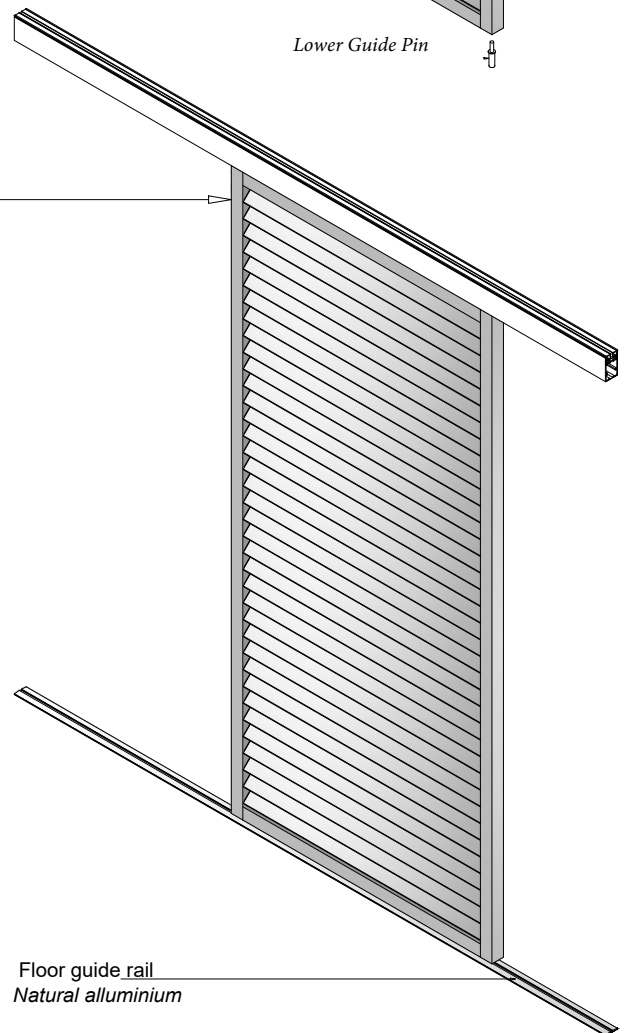
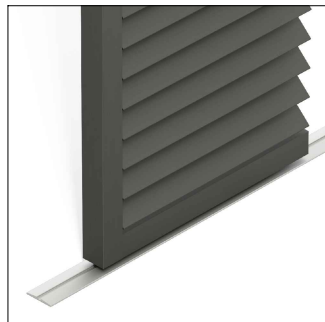

LEVANTE - Sliding Screens

TWO AESTHETIC SOLUTIONS:

LEVANTE MINIMAL

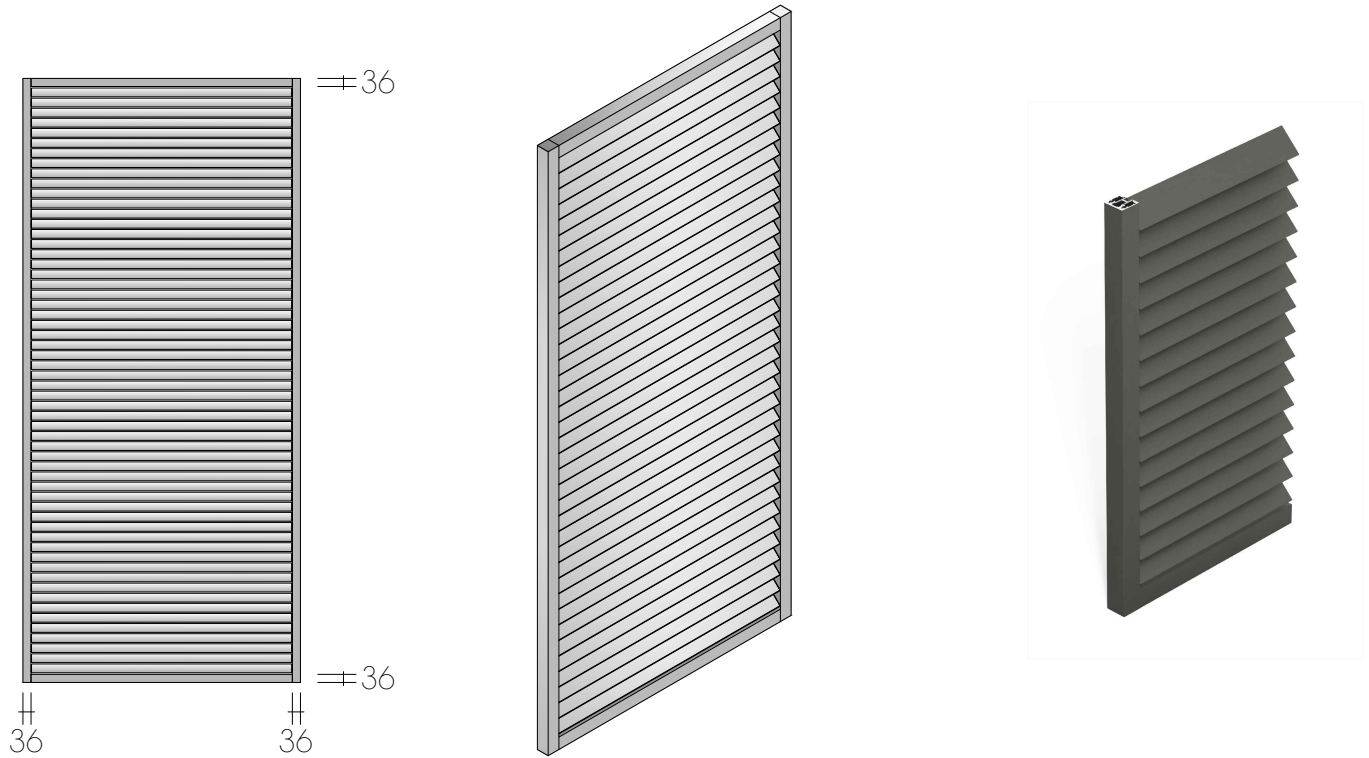

LEVANTE PLUS

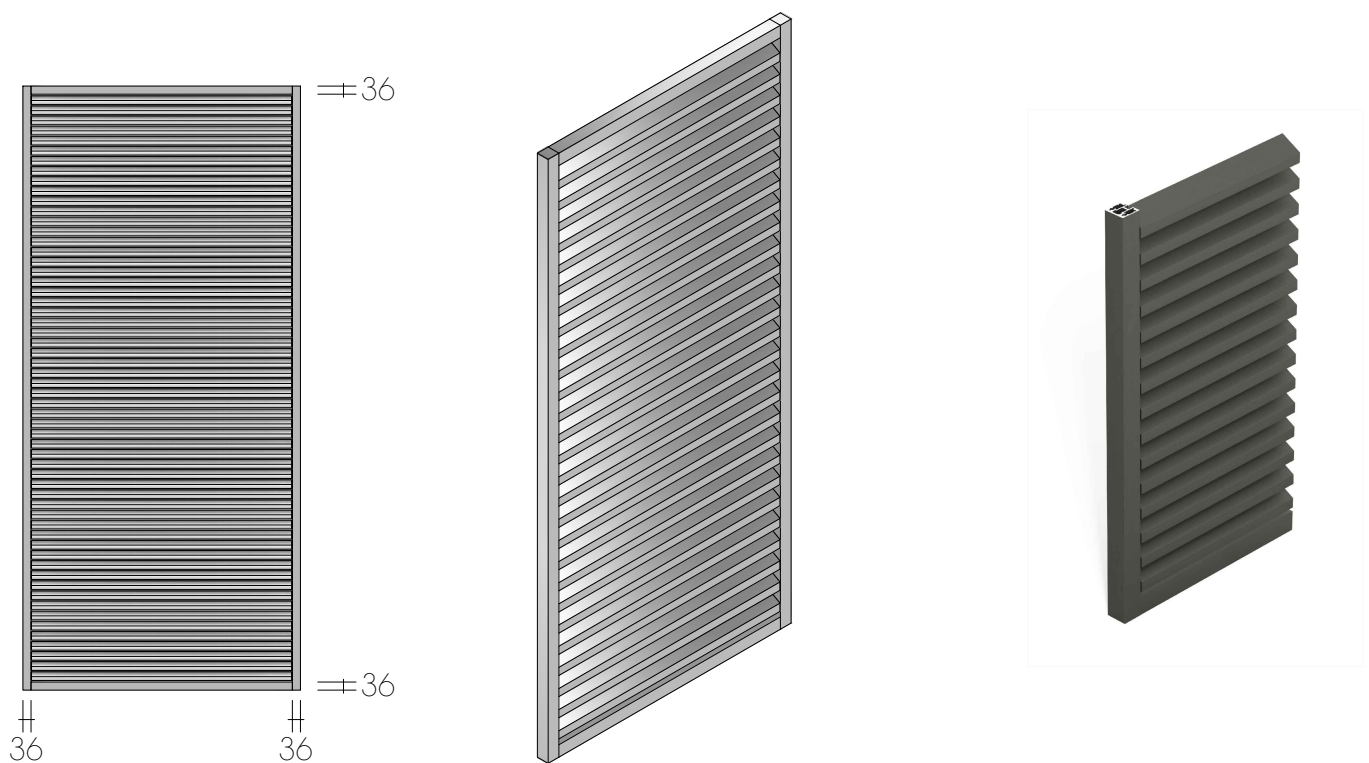

Ceiling rail

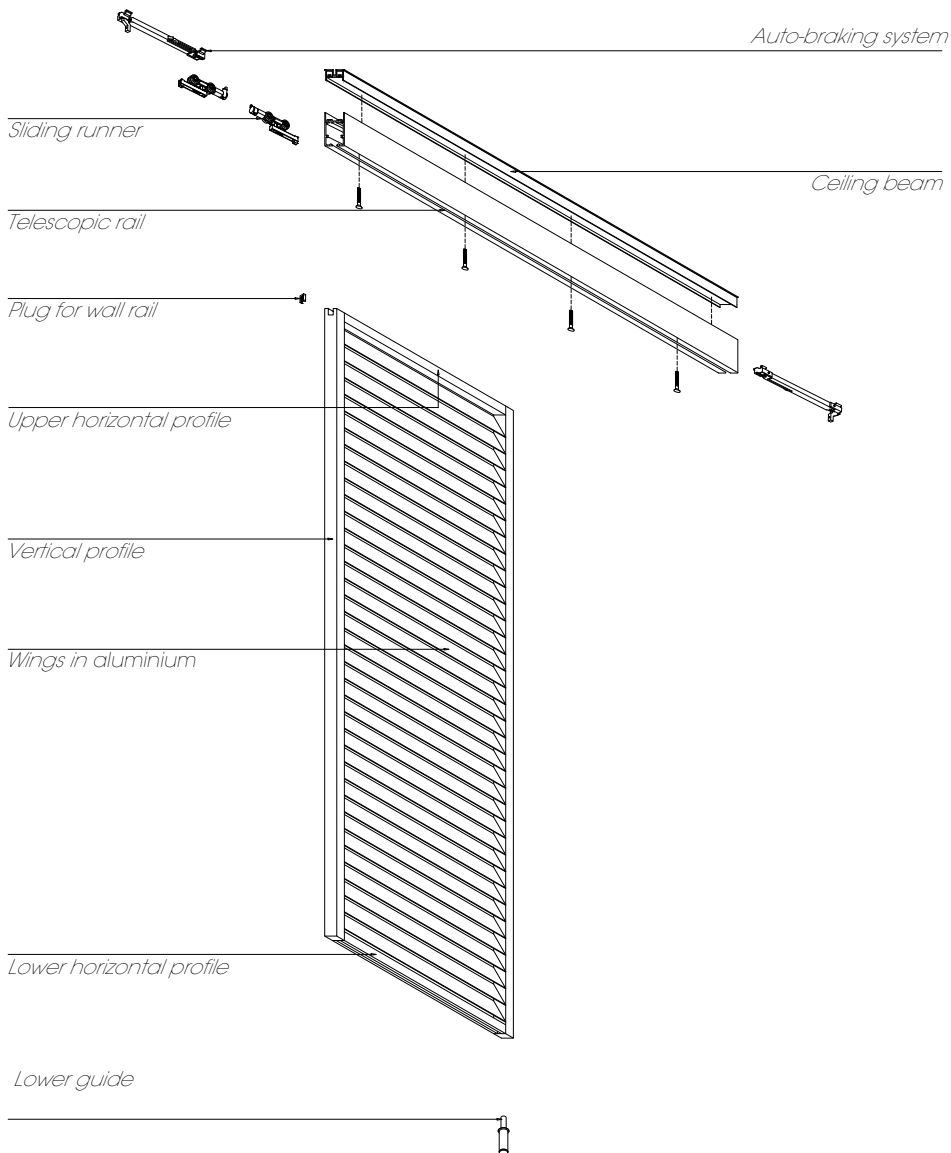
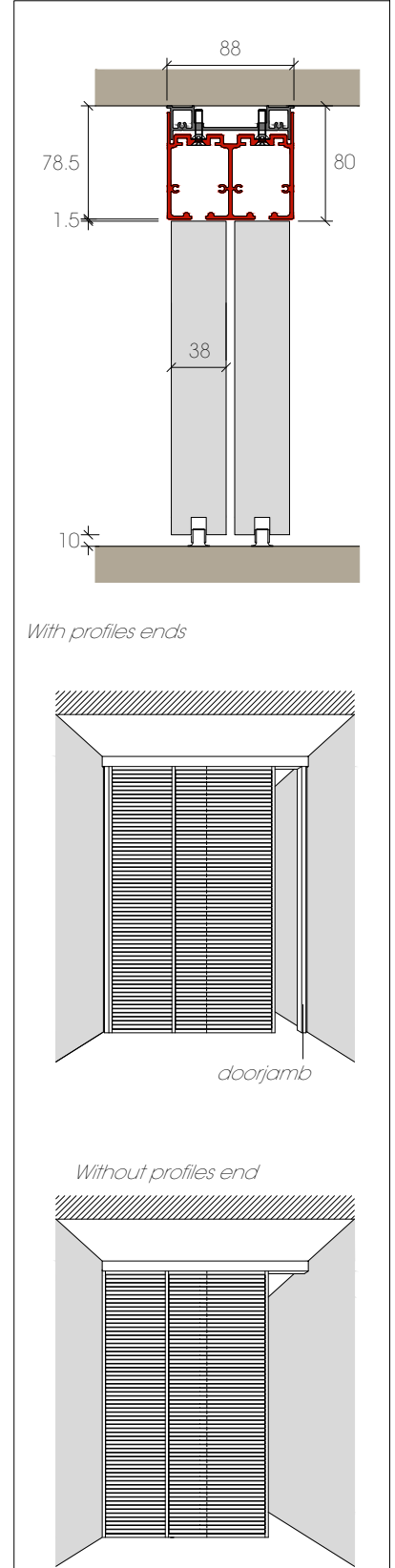

Ceiling rail

ASSEMBLING

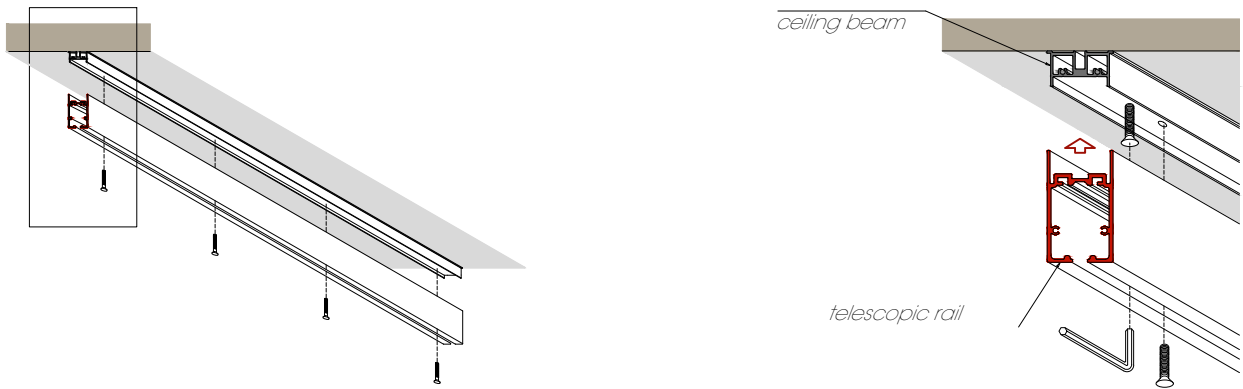

RAIL'S REGULATION

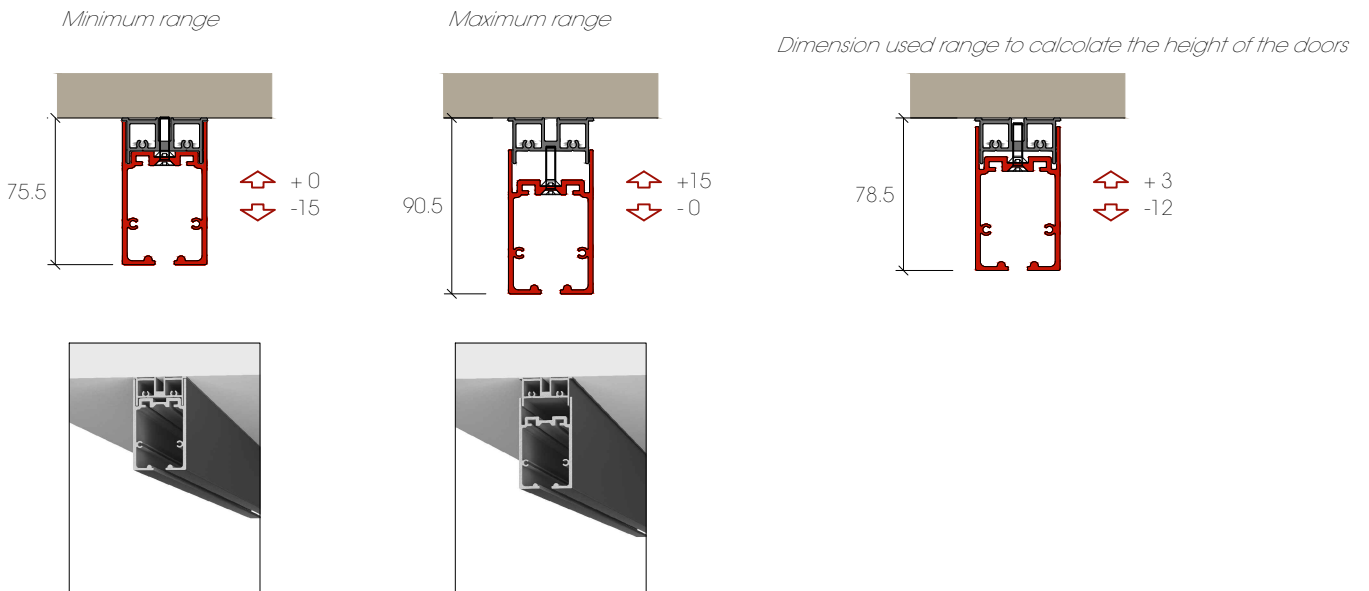

DOOR'S REGULATION

Sliding runner with vertical regulation of the door

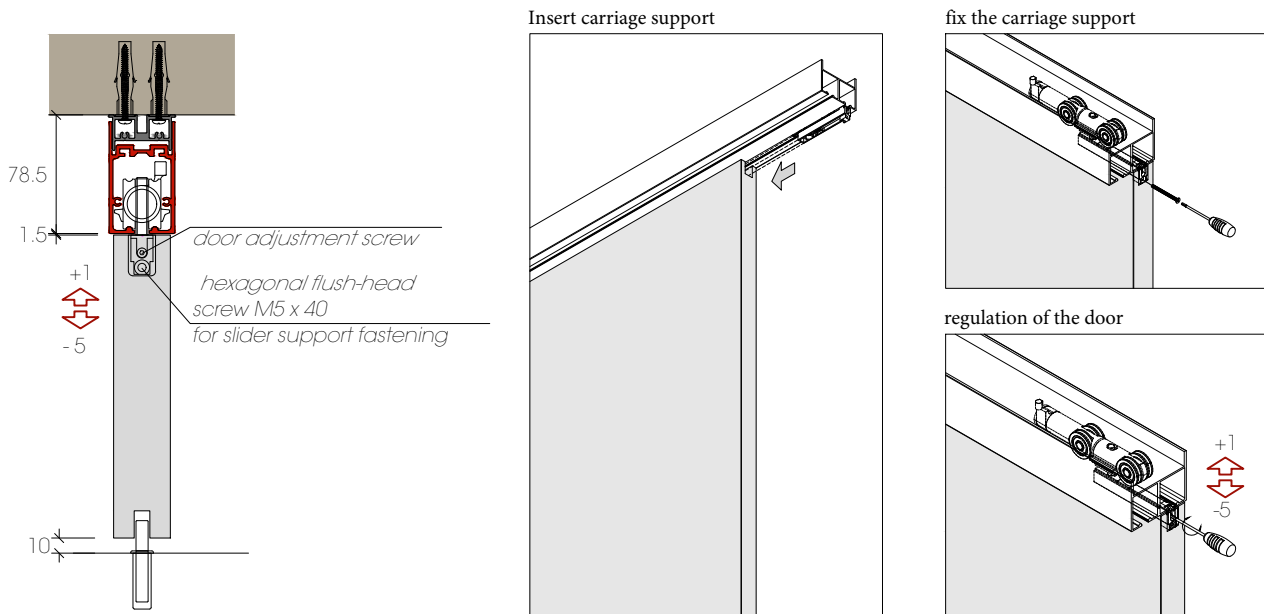

Applications

CEILING RAILS

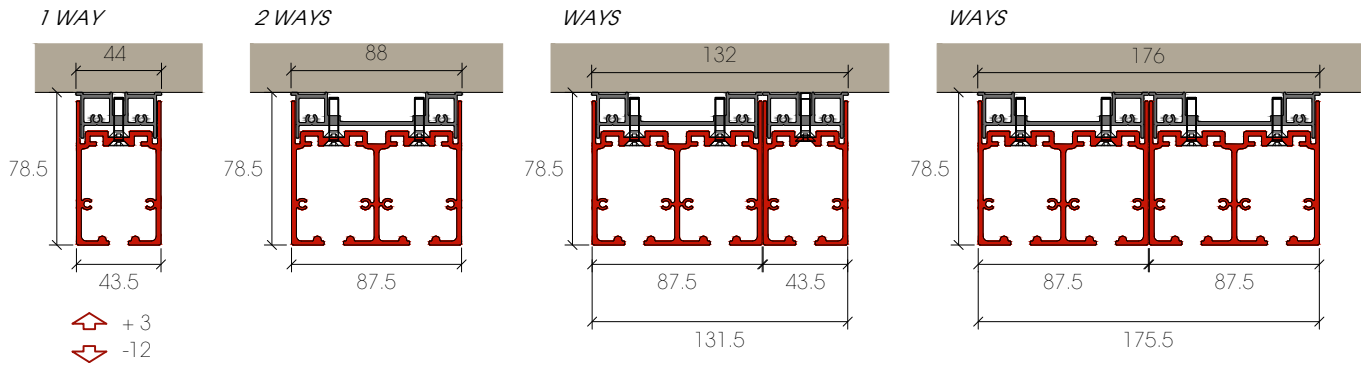

BUILT-BEAM RAIL

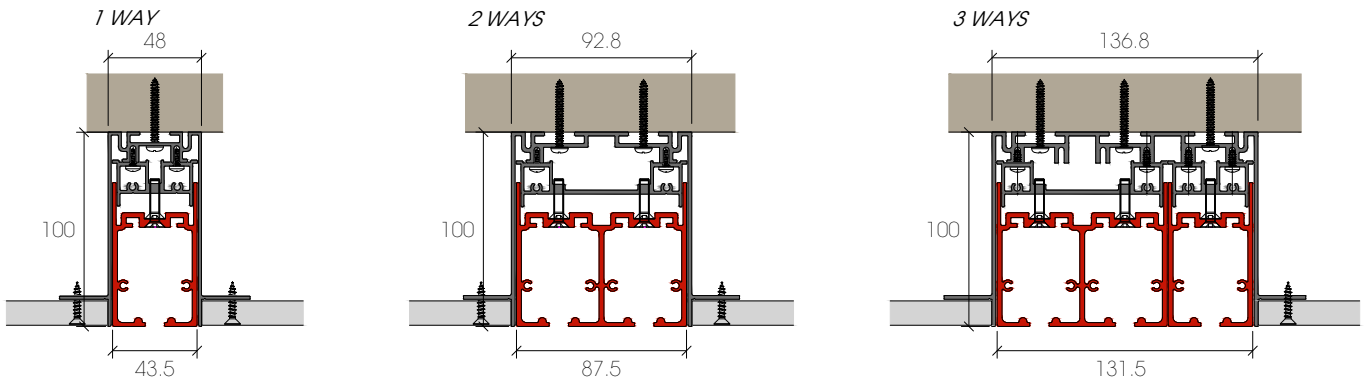

COMPOSITION

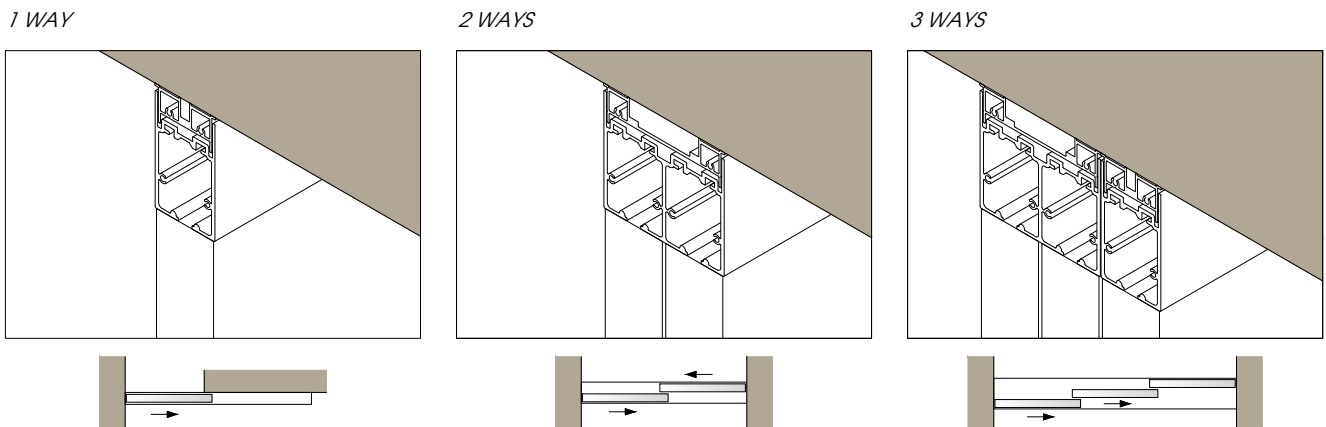

Counter rail for concealed ceiling mount rail

BUILT-BEAM CEILING

one way counter rail with 2 tongues

two ways counter rail with 2 tongues

three ways counter rail with 2 tongues

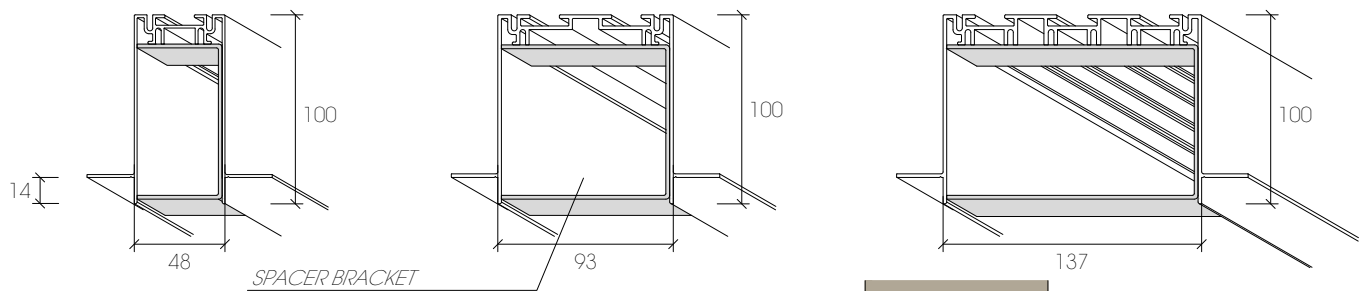

ASSEMBLING COUNTER RAIL

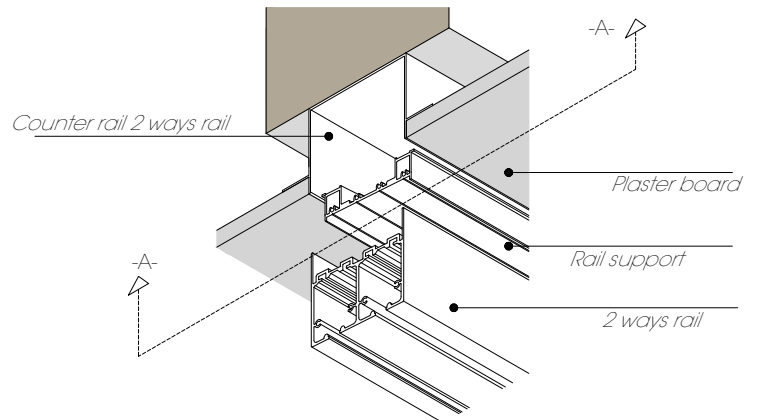
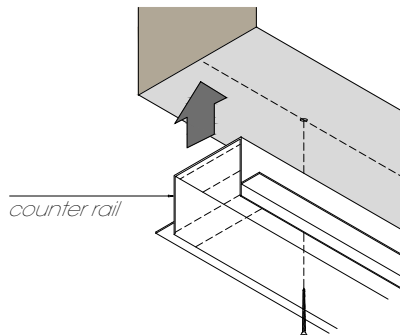

WALL-MOUNTED CEILING MOUNTED

one way counter rail with 1 tongue

two ways counter rail with 1 tongue

three ways counter rail with 1 tongue

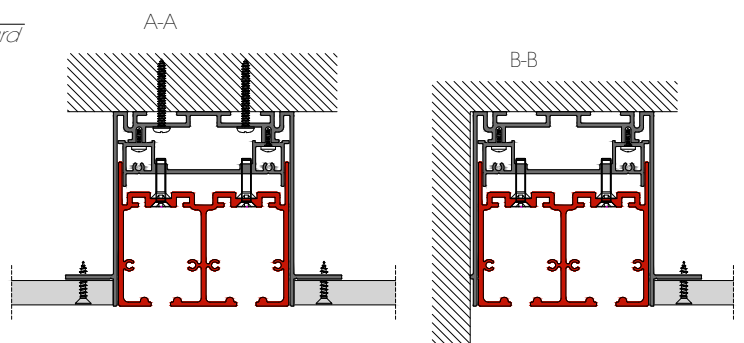
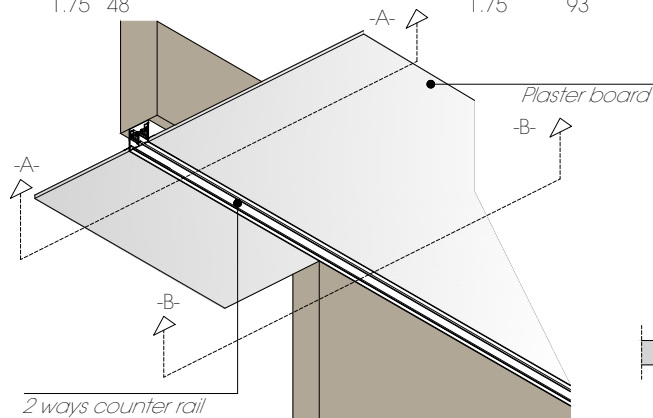
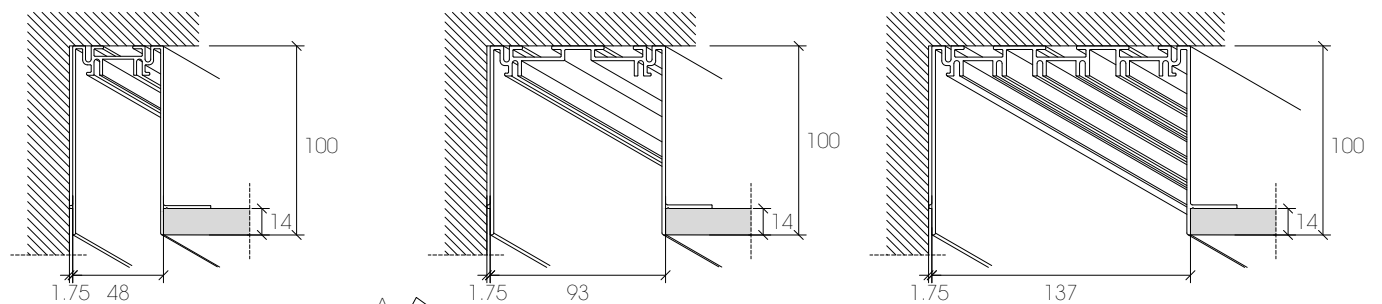

Ceiling rail Height Calculation

RULES TO CALCULATE THE HEIGHT OF THE DOORS WITHOUT COUNTER RAIL

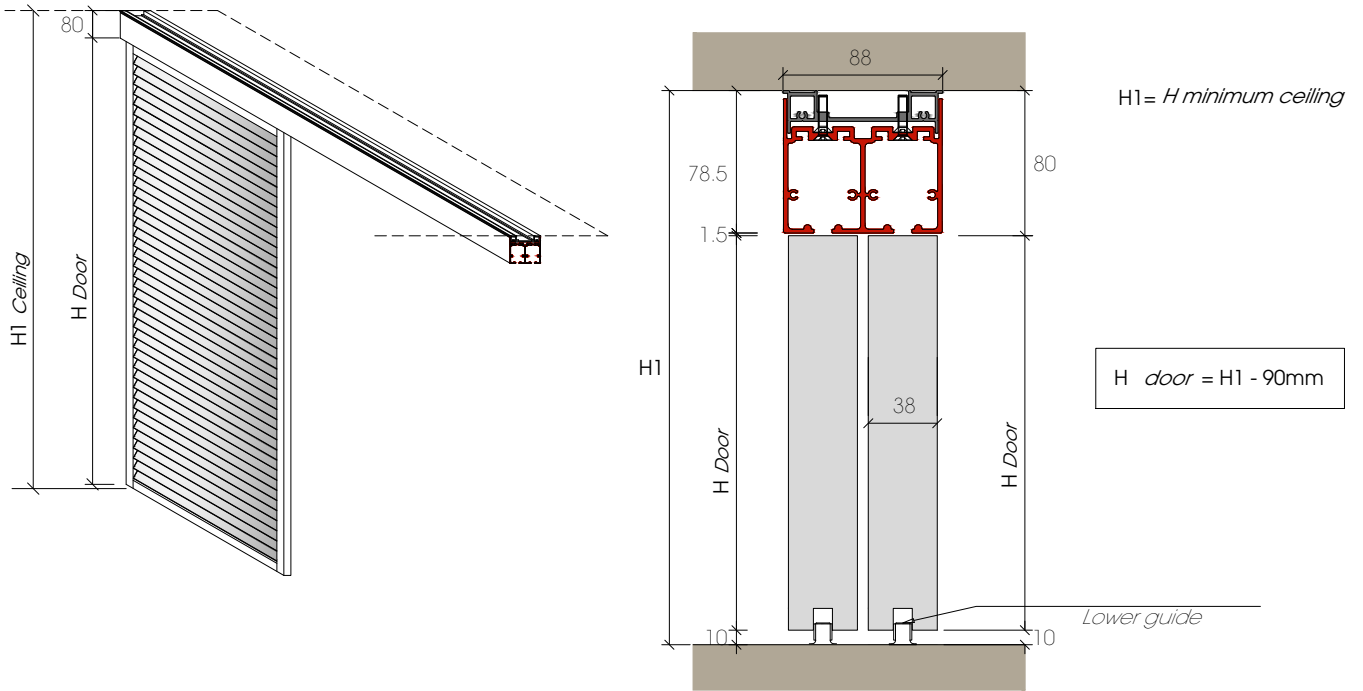

-RULES TO CALCULATE THE HEIGHT OF THE DOORS WITH COUNTER RAIL

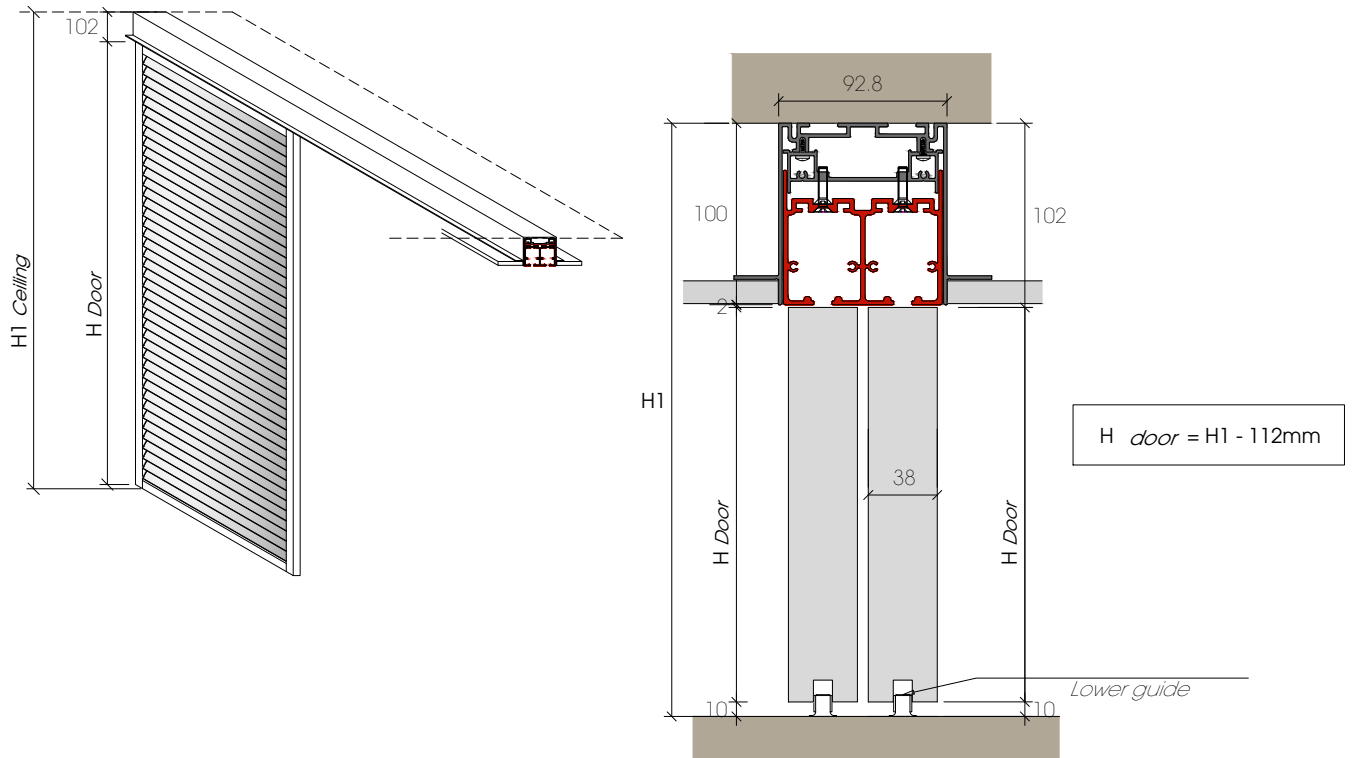

End profiles

DOORJAMB END

Only for sliding door with lower guide

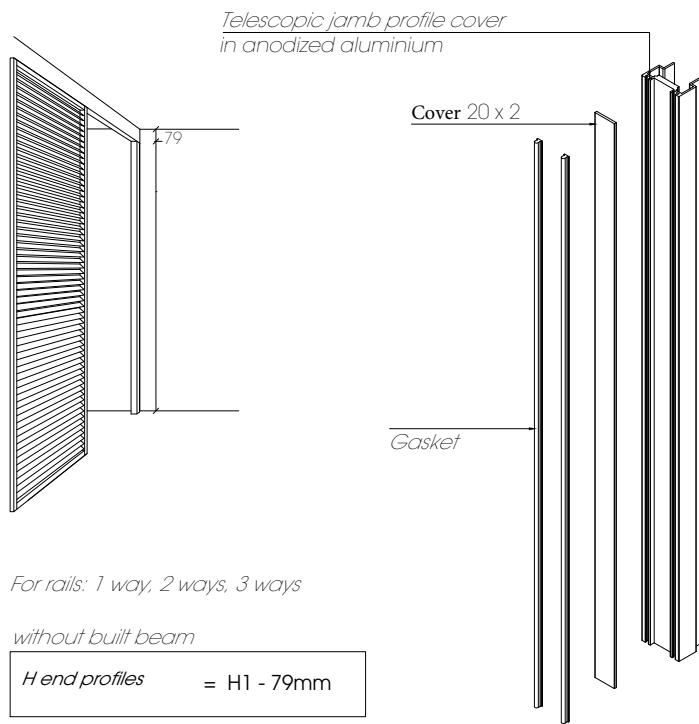

For rails: 1 way, 2 ways, 3 ways

without built beam

H end profiles = H1 - 79mm

with built beam

H end profiles = H1 - 101mm

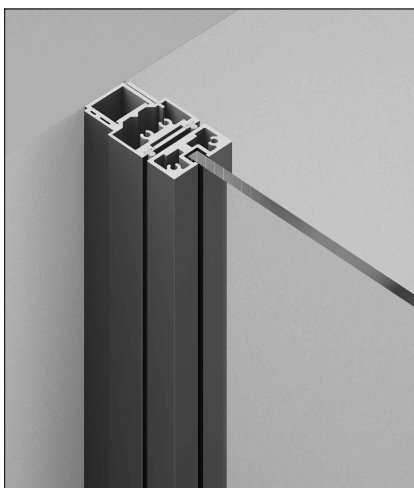
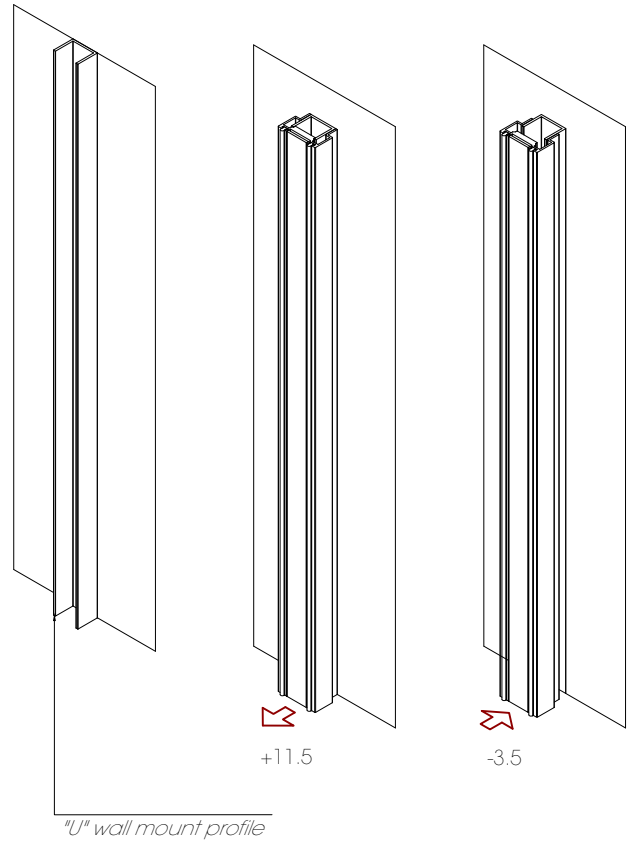

DIMENSION USED RANGE

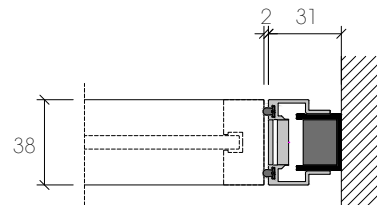

MINIMUM RANGE

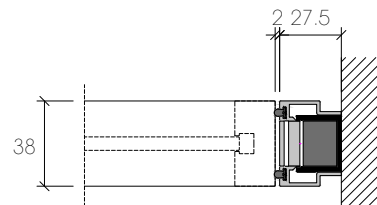

MAXIMUM RANGE

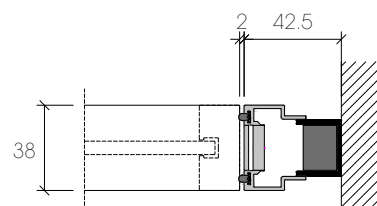



- The wall rail is made of:
- Anodized aluminium beam
- Anodized aluminium 1 and 2 way rail
- Side cover plugs

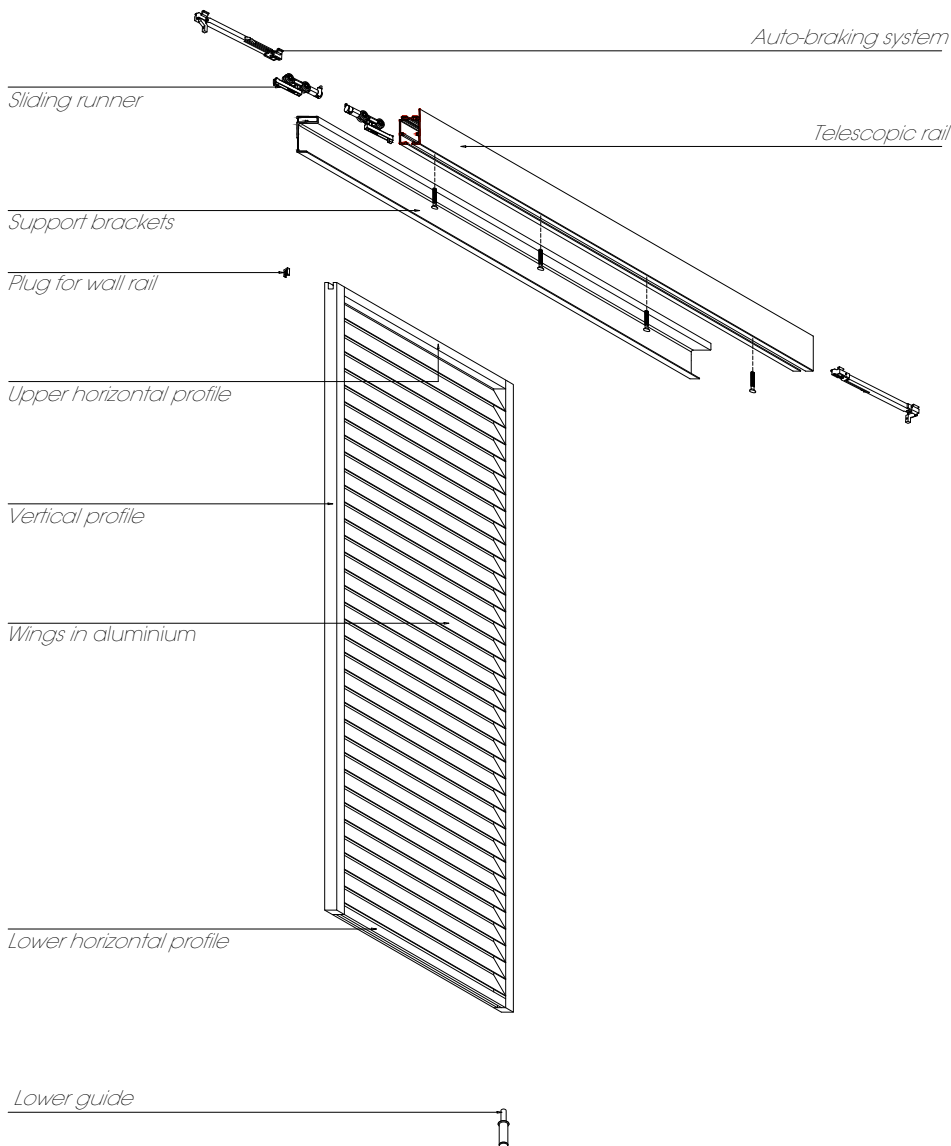
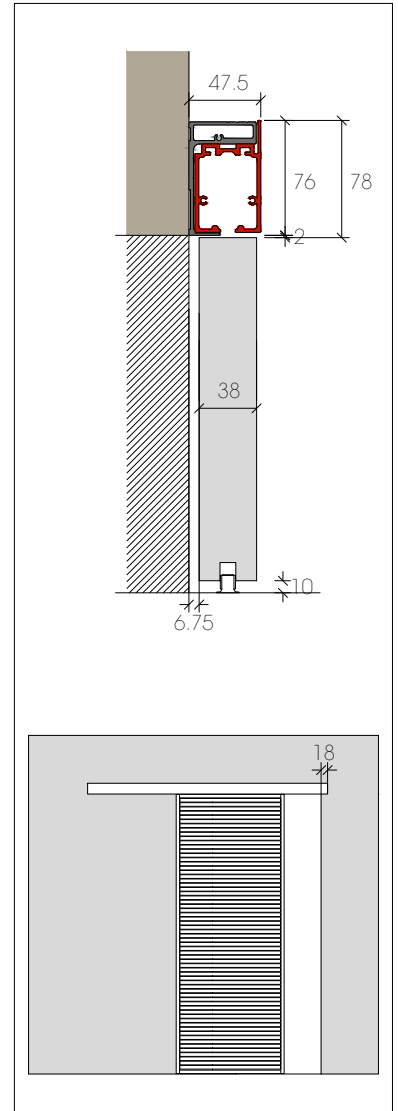

Wall rail

COMPOSITION without built beam

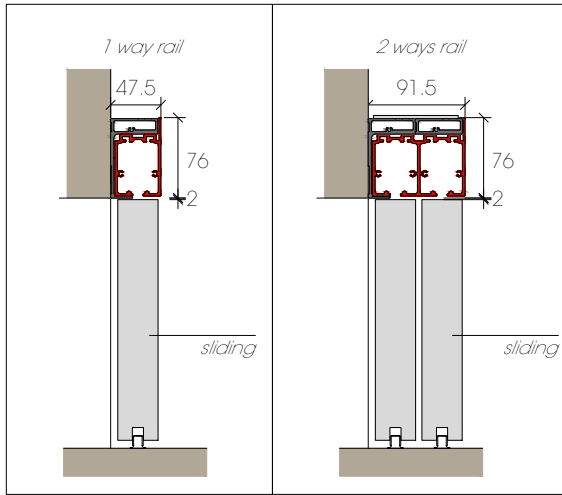

COMPOSITION without built beam

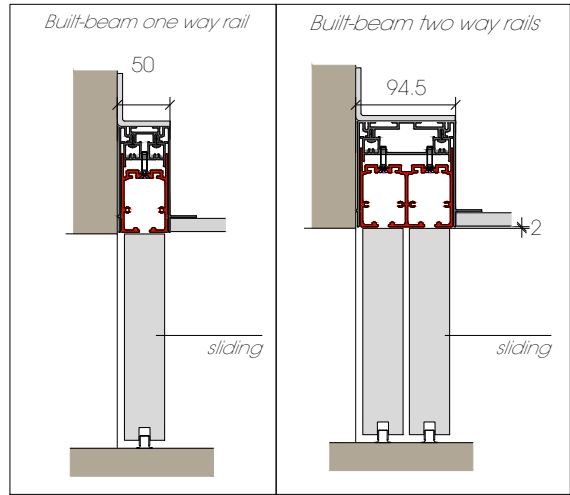

WALL RAIL

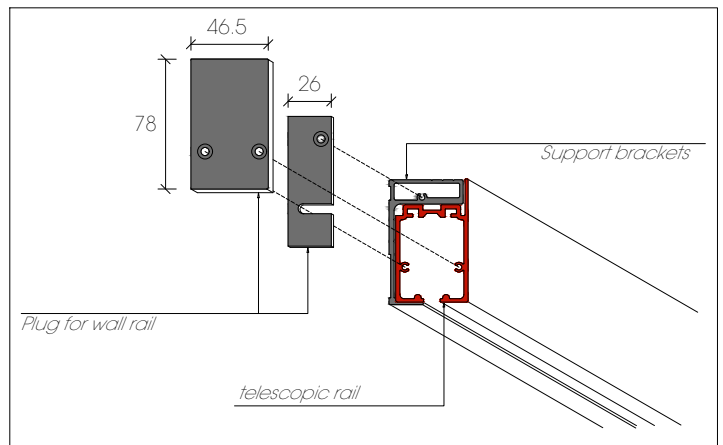
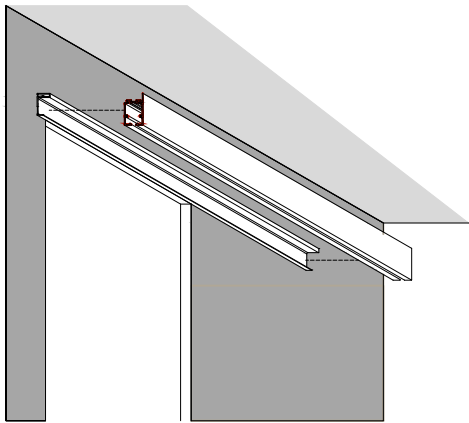

RAIL'S REGULATION



DOOR'S REGULATION

Sliding runner with vertical regulation of the door

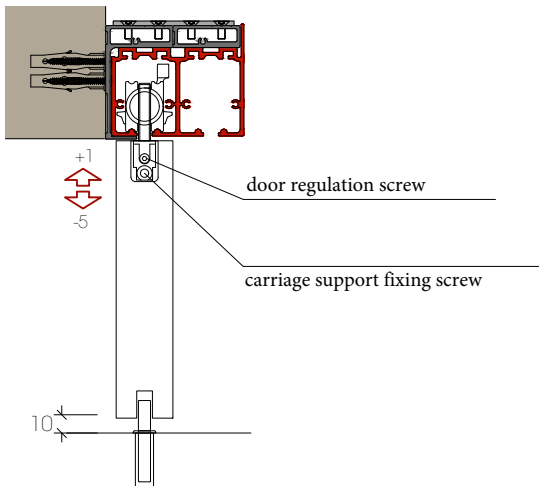

insert the carriage support

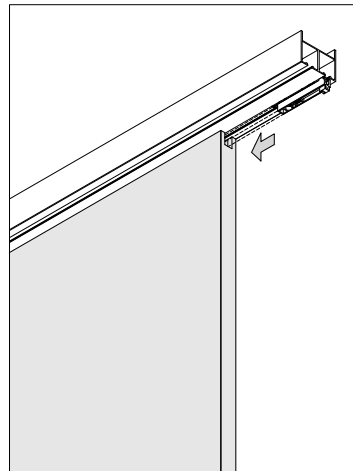

fix the carriage support to the door

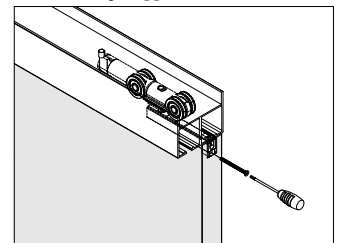

regulate the door height

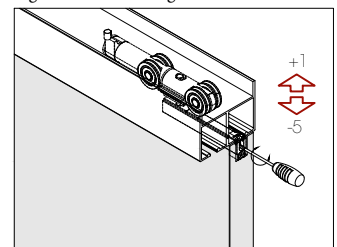

Wall rail

RULES TO CALCULATE THE HEIGHT OF THE DOORS WITHOUT COUNTER RAIL

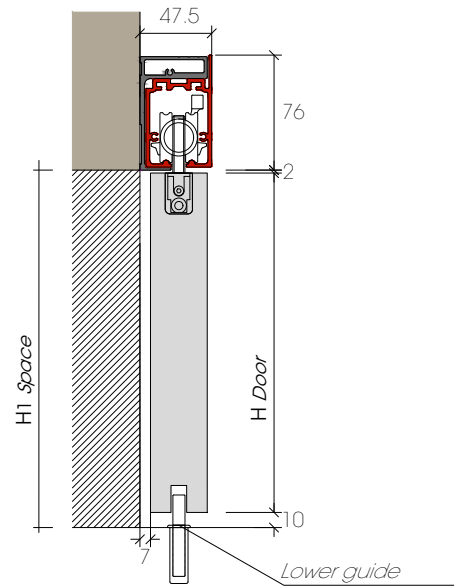
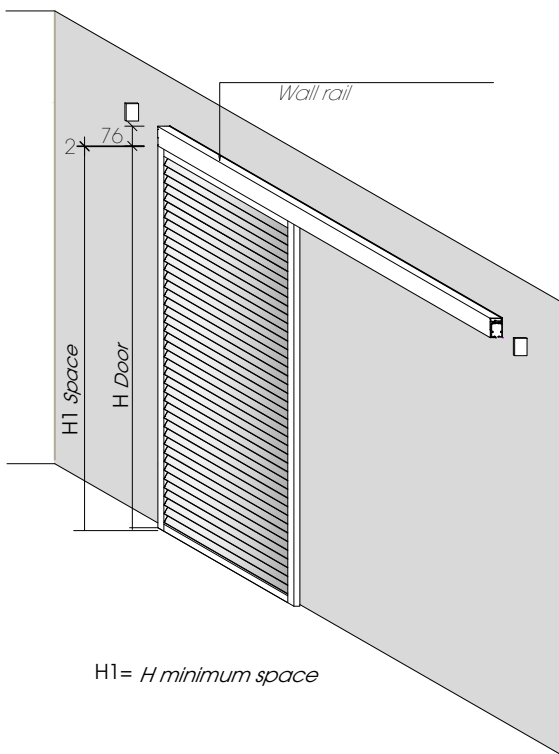

$$H_{door} = H1 - 12\text{mm}$$

RULES TO CALCULATE THE HEIGHT OF THE DOORS WITH COUNTER RAIL

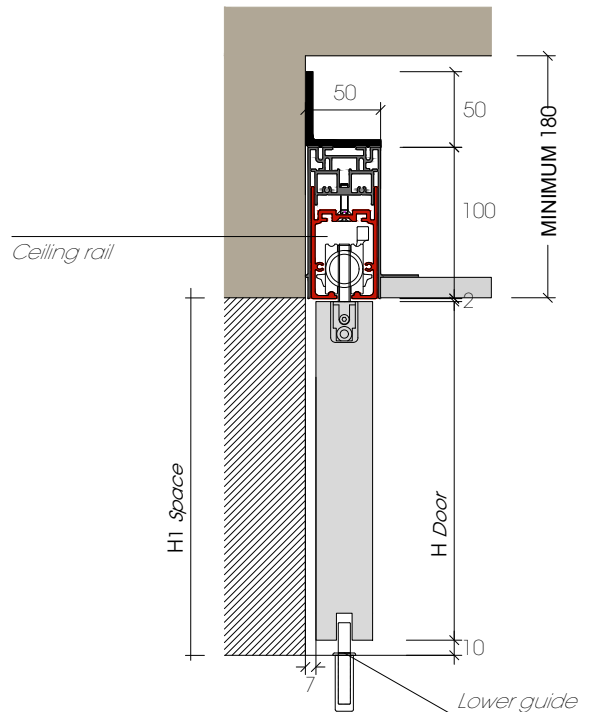
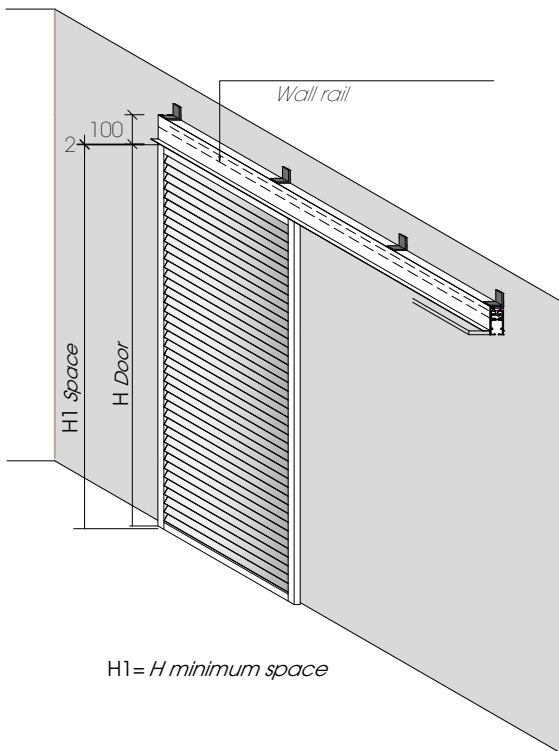

$$H_{door} = H1 - 12\text{mm}$$

Wall rail

RAIL TO THE WALL-TO THE CEILING WITH CEILING FIXATION WITHOUT COUNTER RAIL

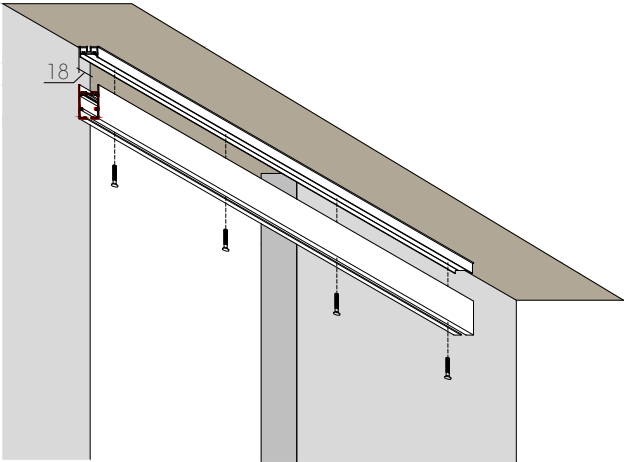
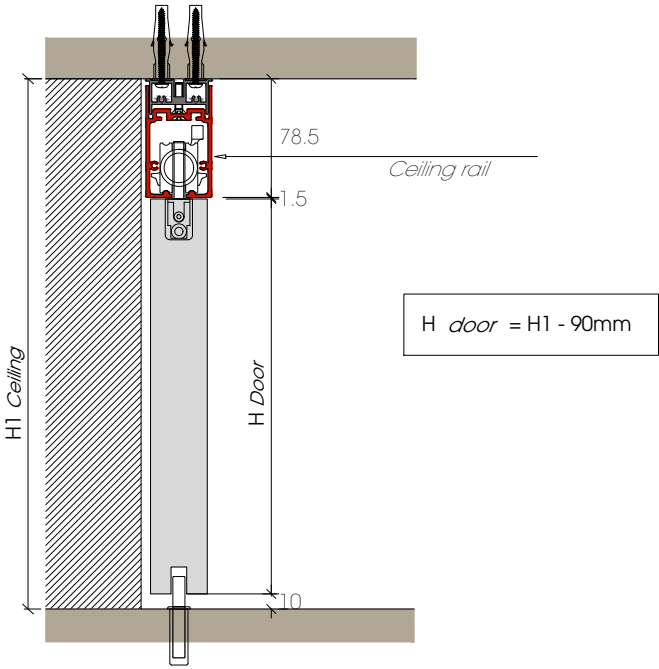

RAIL TO THE WALL-TO THE CEILING WITH CEILING FIXATION WITH COUNTER RAIL

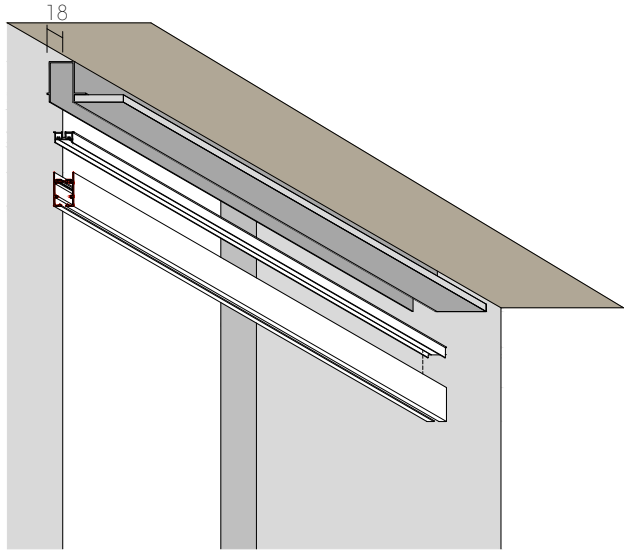
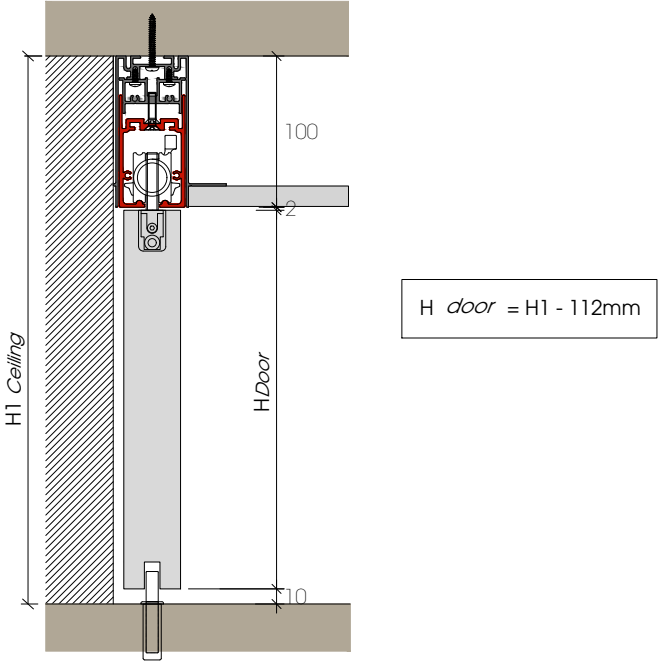

LEVANTE SLIDING DOORS - With lower guide

Opening of sliding doors for CELLING RAIL with doorjambs end profiles

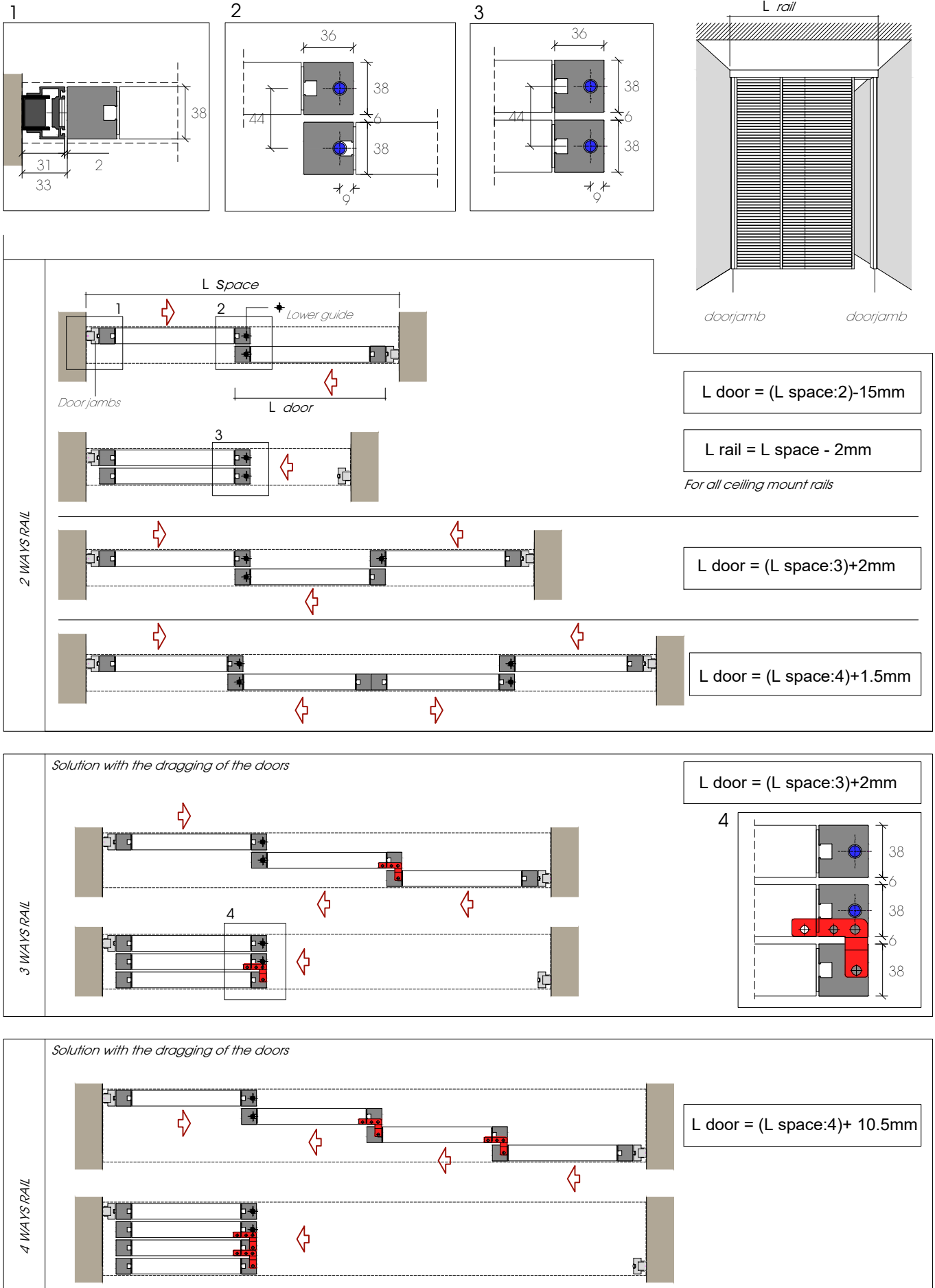

LEVANTE SLIDING DOORS - With lower guide

Opening of sliding doors for **CELLING RAIL** without doorjamb end profiles

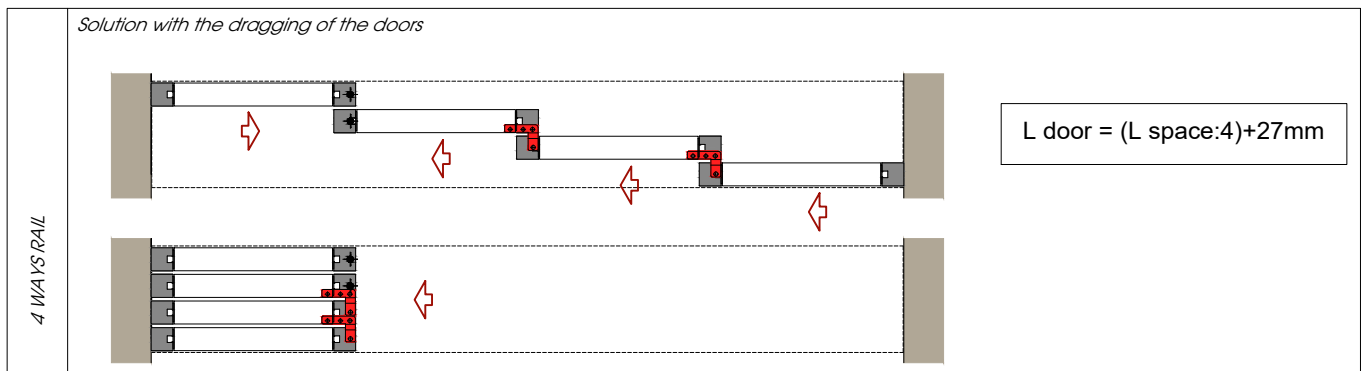
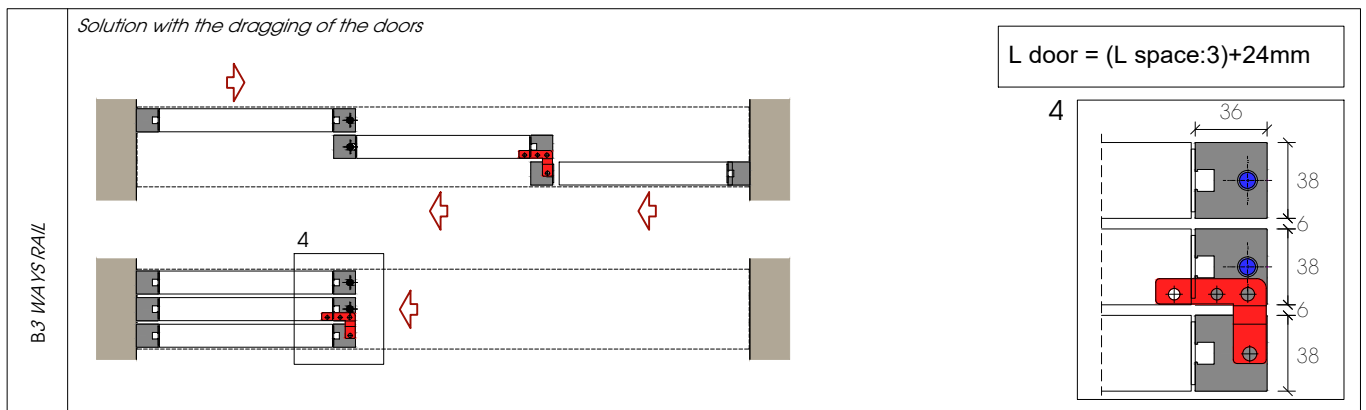
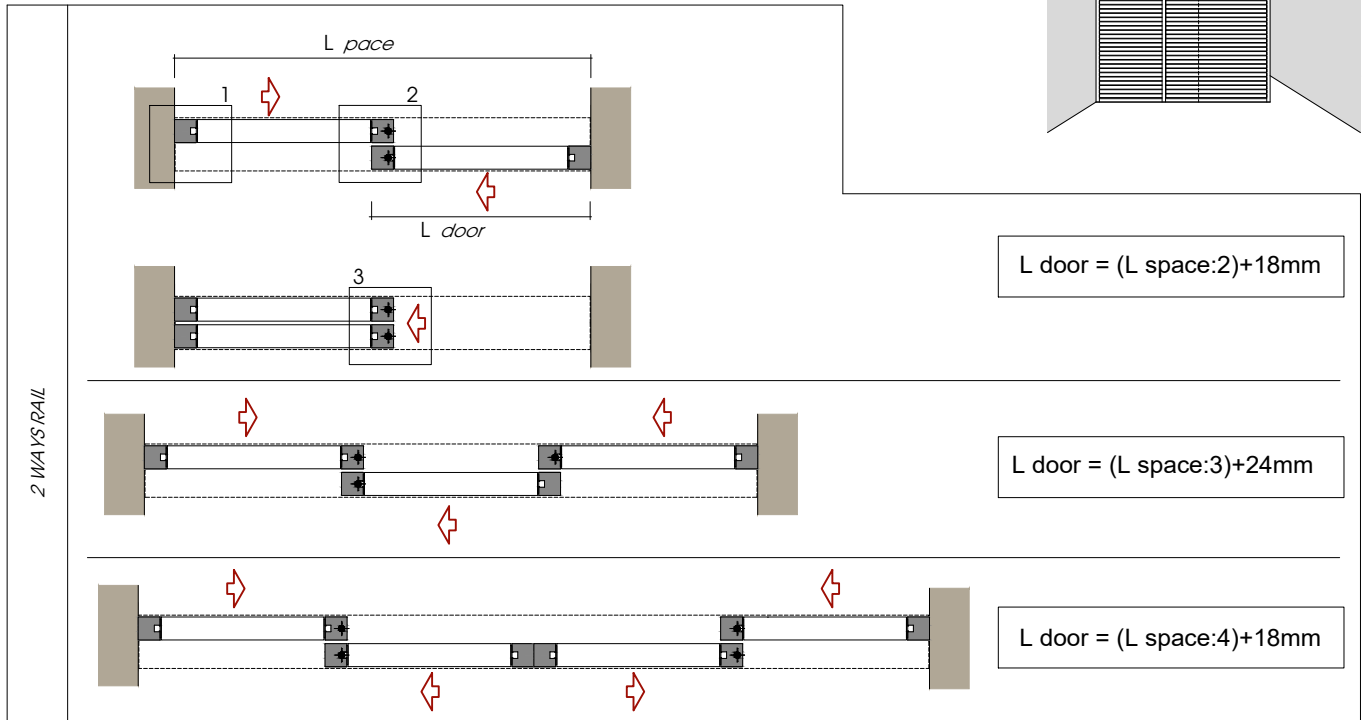
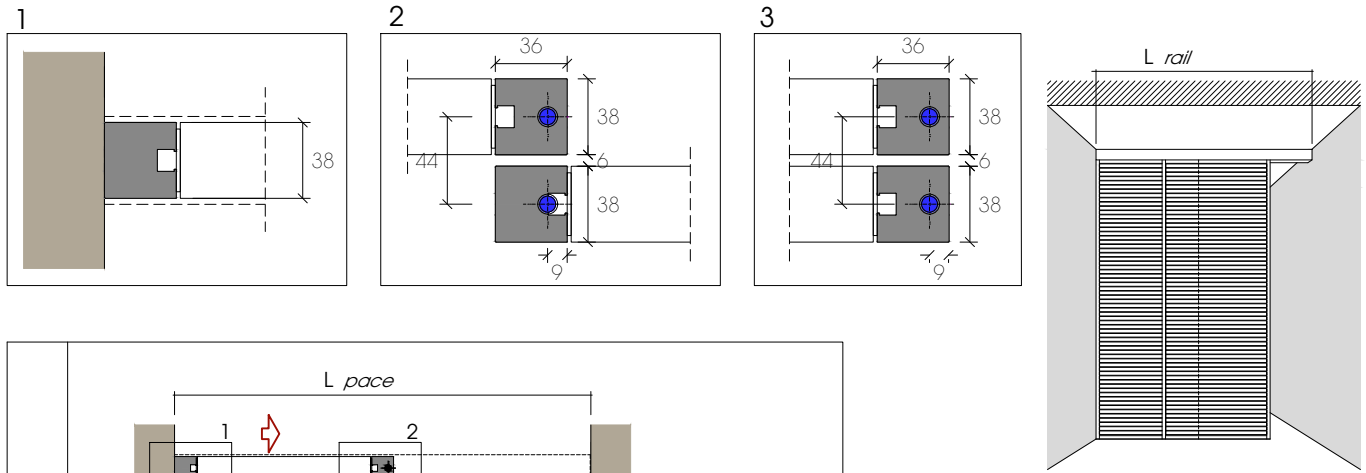

LEVANTE SLIDING DOORS - With lower guide

Opening of sliding doors for wall

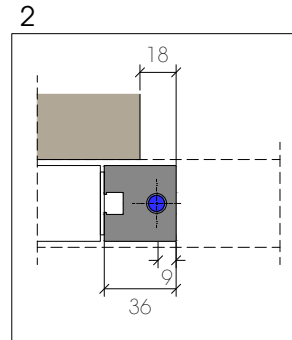
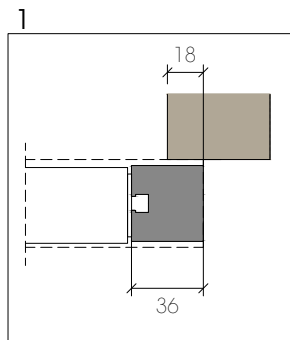
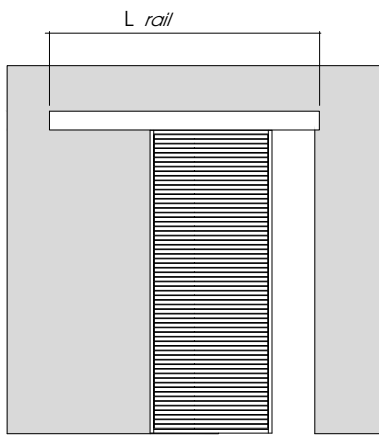

1 WAY RAIL

$L \text{ door} = L \text{ space} + 36\text{mm}$
 $L \text{ rail} = (L \text{ door} \times 2) - 18\text{mm}$

1 WAY RAIL

$L \text{ door} = L \text{ space} + 18\text{mm}$
 $L \text{ rail} = (L \text{ door} \times 2) - 18\text{mm}$

1 WAY RAIL

$L \text{ door} = (L \text{ space} : 2) + 18\text{mm}$
 $L \text{ rail} = (L \text{ door} \times 4) - 36\text{mm}$

LEVANTE SLIDING DOORS *With lower guide*

Opening of sliding doors for wall

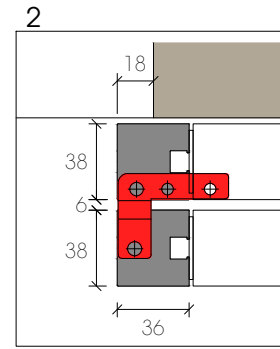
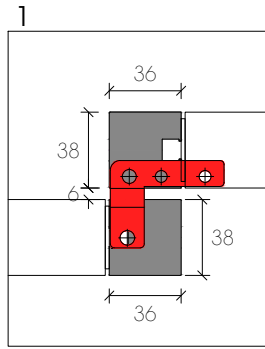
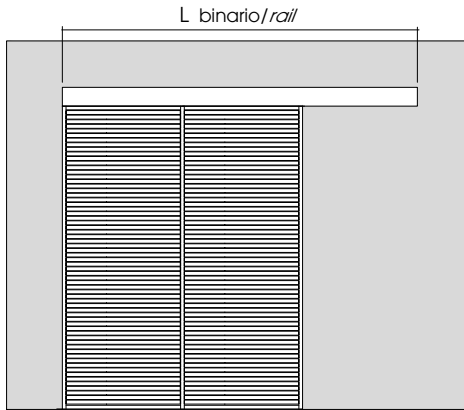

Solution with the dragging of the doors (telescopic)

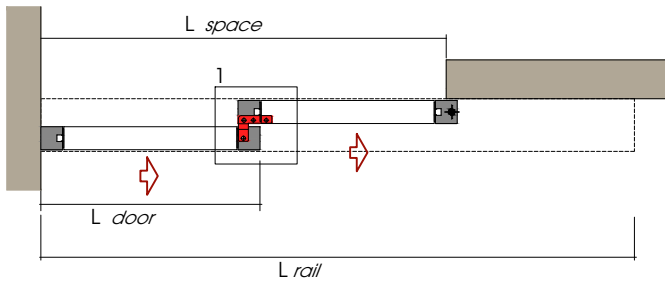

$$L \text{ door} = (L \text{ space} : 2) + 27\text{mm}$$

$$L \text{ rail} = (L \text{ door} \times 3) - 36\text{mm}$$

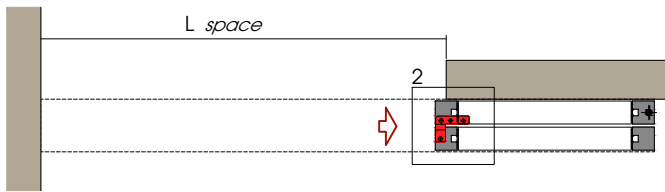

Indicate the opening and position of the doors

2 WAYS RAIL

$$L \text{ door} = (L \text{ space} : 4) + 27\text{mm}$$

$$L \text{ rail} = (L \text{ door} \times 6) - 27\text{mm}$$

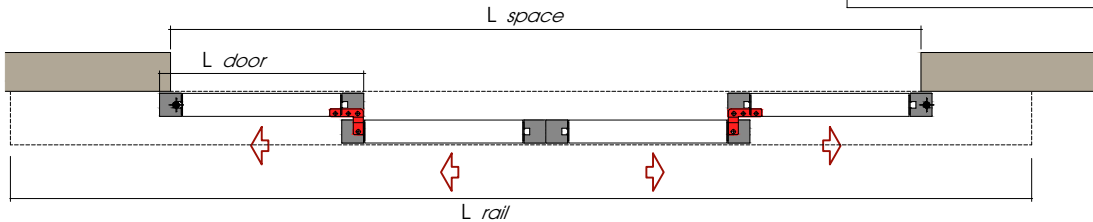

LEVANTE SLIDING DOORS - *With lower guide*

Opening of sliding doors for wall

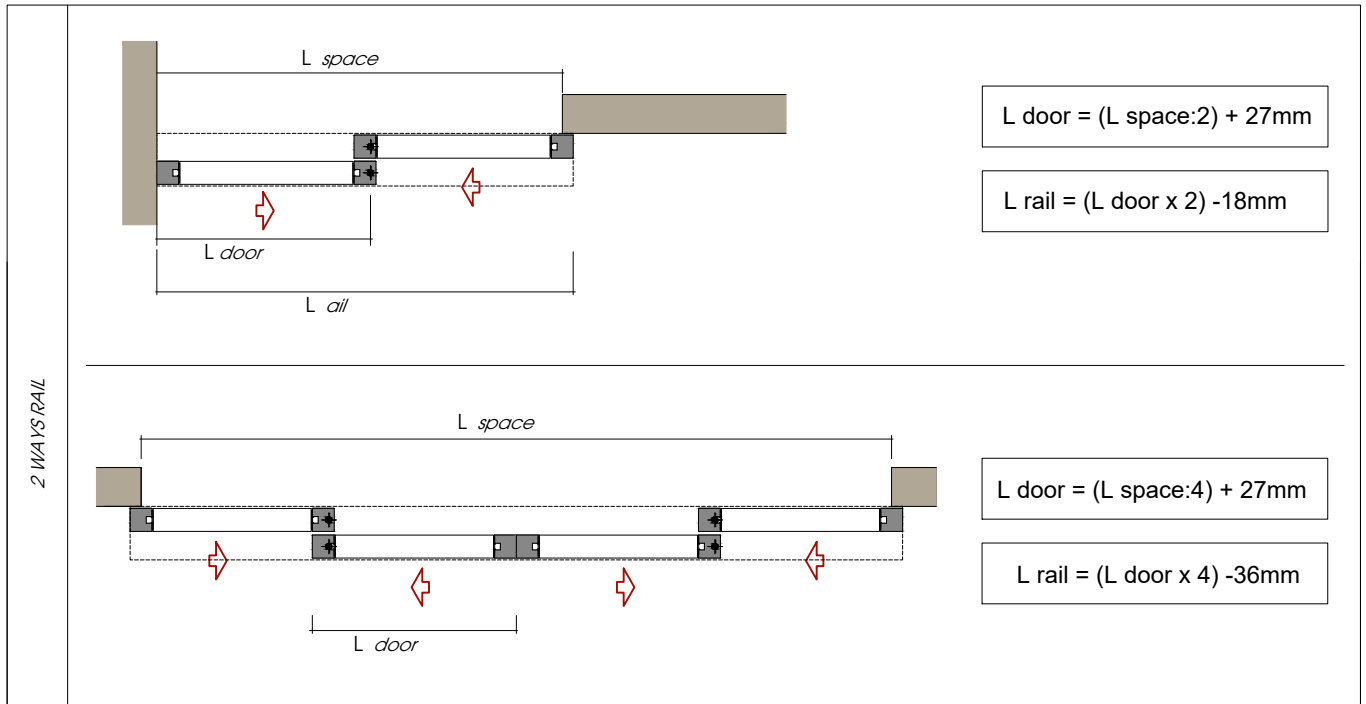

SOLO BINARIO A PARETE-SOFFITTO

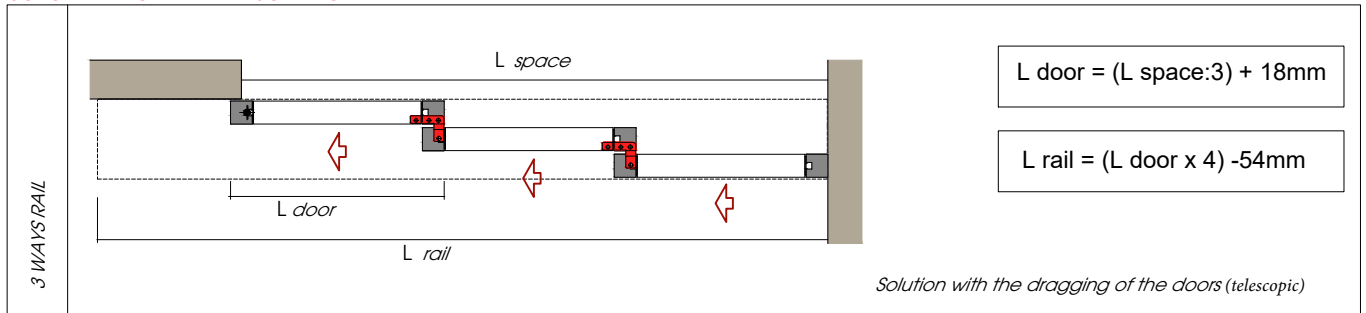

LEVANTE - FREE Sliding door with Floor Tracks

VERTICAL SECTIONS

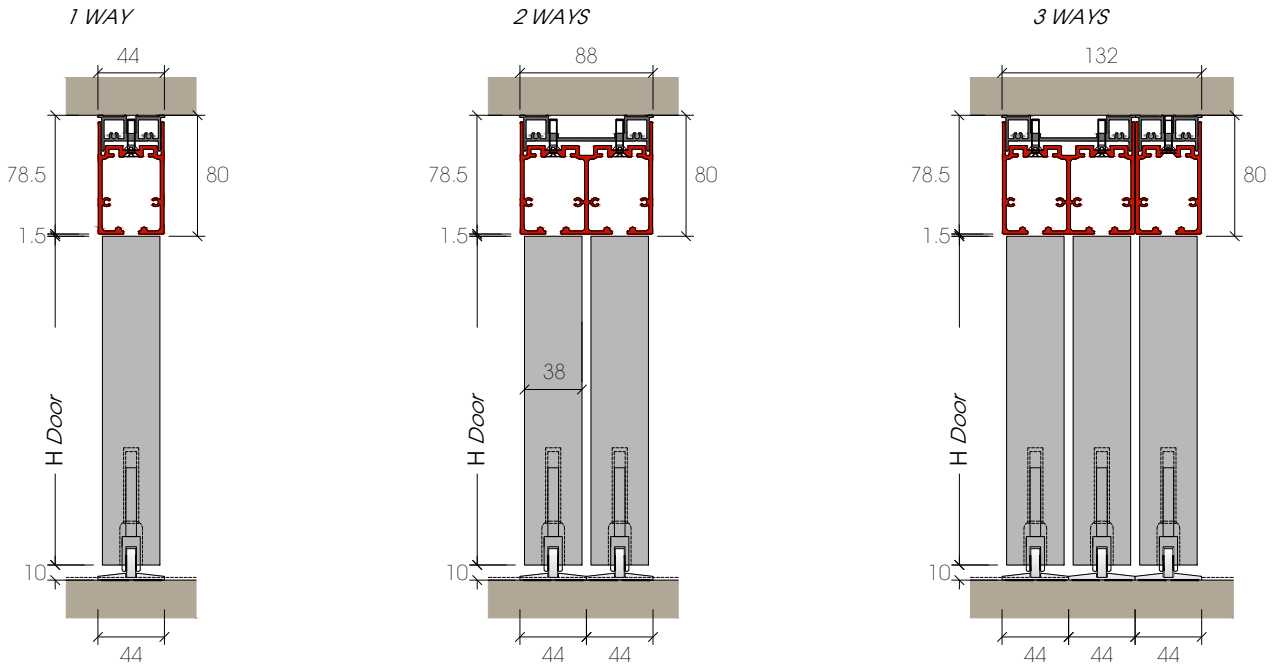

For ceiling rails technical features see page 5 - 6 - 7

MINIMUM RANGE

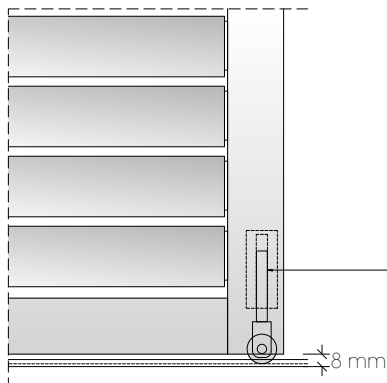

MAXIMUM RANGE

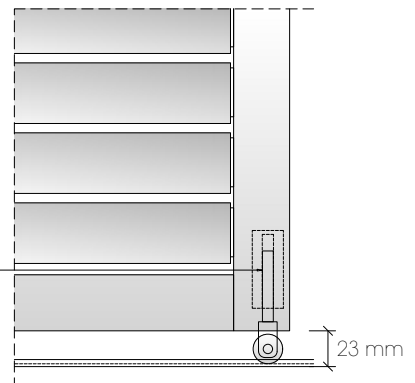

Two telescopic runners
for floor guide

FLOOR TRACKS

Supplied by the linear metre in maximum length of 5900 mm with biadhesive tape for floor fixing without screws

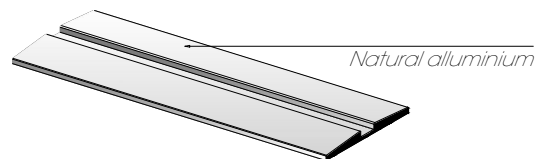
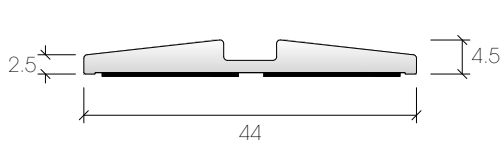

LEVANTE - FREE Sliding door with Floor Tracks

HORIZONTAL SECTIONS

Free movement of the door

EXAMPLES OF CONFIGURATION

WAY

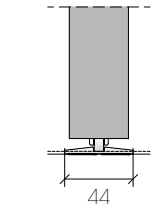
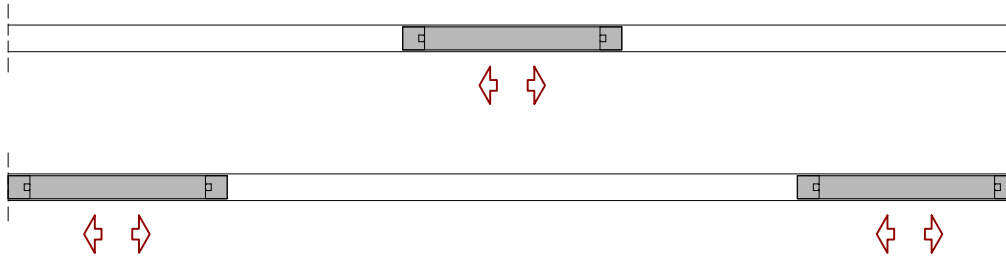

2 WAYS

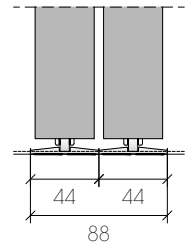
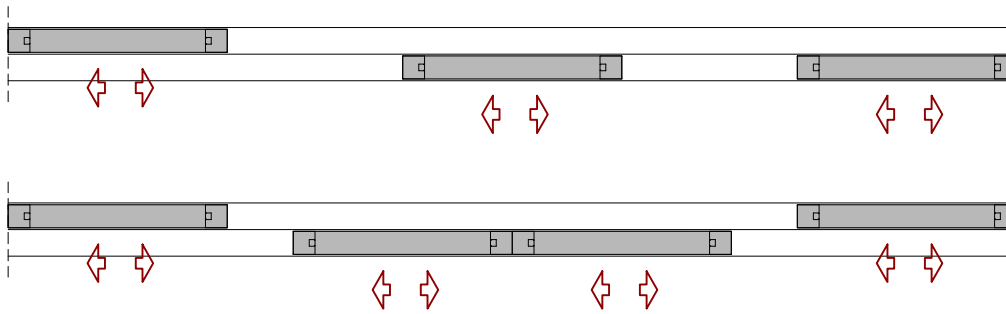

3 WAYS

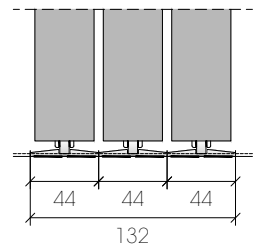
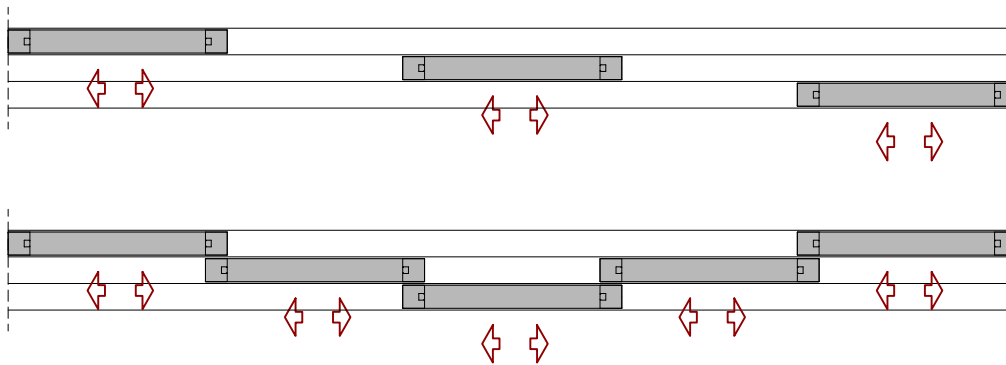

LEVANTE MINIMAL

GENERAL FEATURES OF THE LEVANTE MINIMAL DOORS

Handle not needed. When required, add:

HANDLE X1

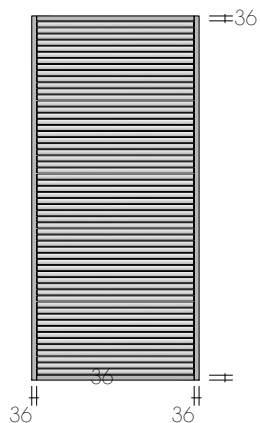
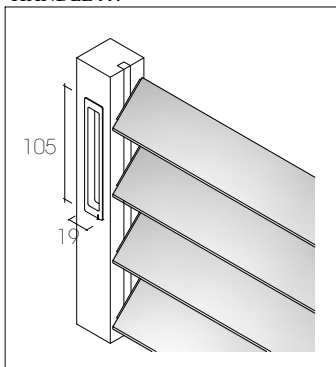

: The price includes:
 Sliding runners
 Auto-braking system
 Retractable floor pin

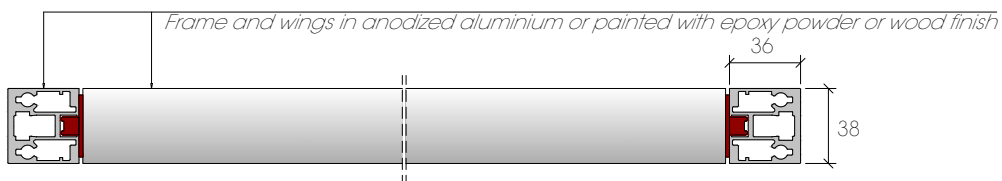

Horizontal section

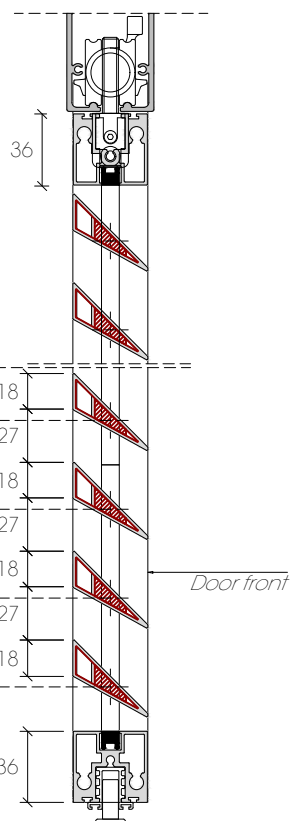
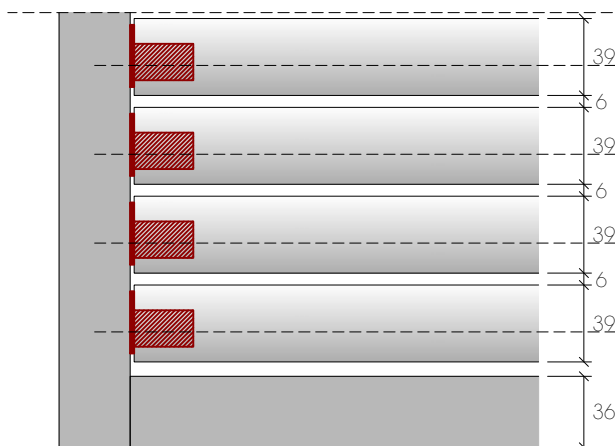
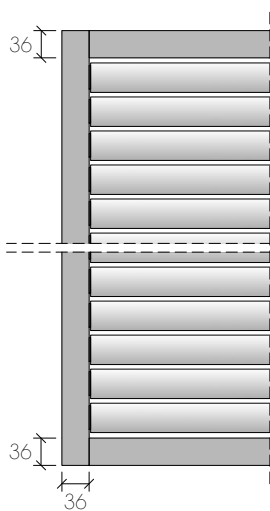

Vertical section

It's possible to add brushes on the top horizontal profile and under the door.

SKID CONTROL FOR SLIDING DOORS

On the sliding door can be applied, upon request, the skid control system.

NOTE: This application is recommended if the floor has a smooth and uniform surface (no ceramics with large grout lines, carpet, delicate floors).

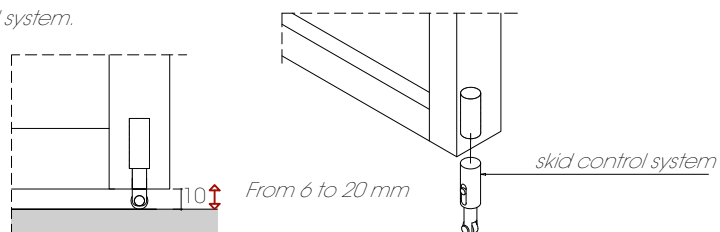

LEVANTE PLUS

GENERAL FEATURES OF THE LEVANTE PLUS DOORS

Handle not needed. When required, add:

HANDLE X1

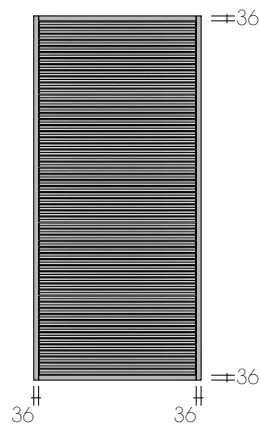
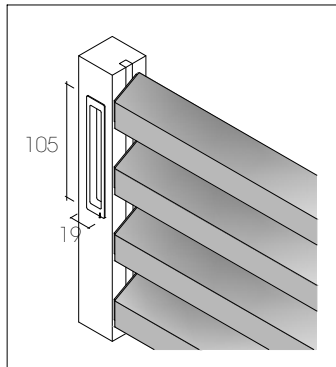

The price includes:

Sliding runners

Auto-braking system

Retractable floor pin

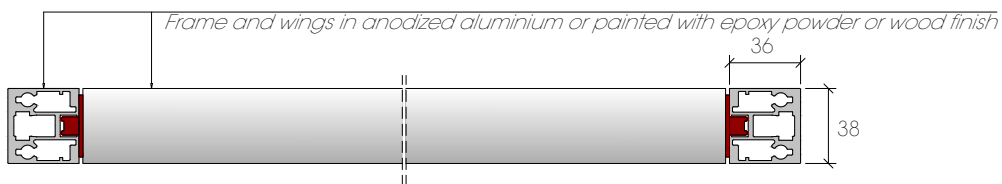

Horizontal section

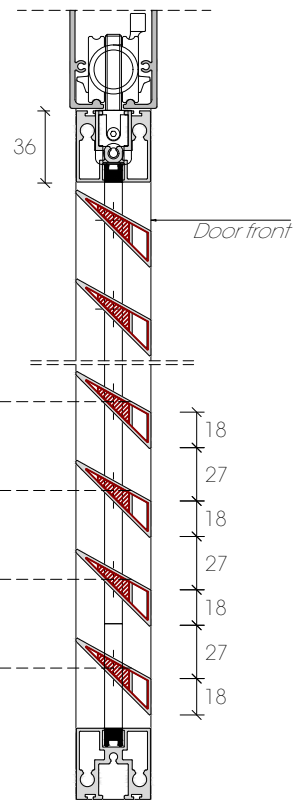
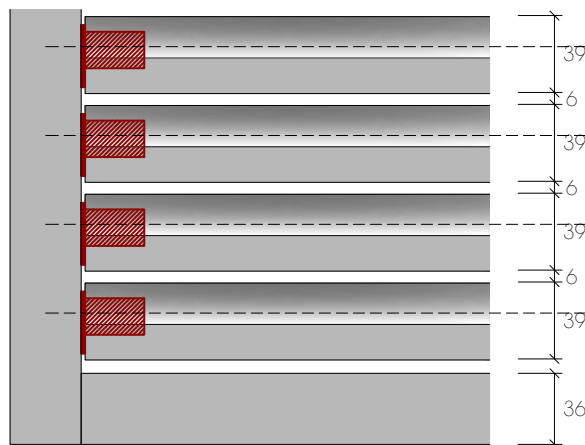
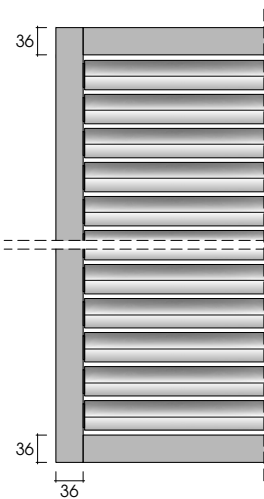

Vertical section

It's possible to add brushes on the top horizontal profile and under the door.

SKID CONTROL FOR SLIDING DOORS

On the sliding door can be applied, upon request, the skid control system.

NOTE: This application is recommended if the floor has a smooth and uniform surface (no ceramics with large grout lines, carpet, delicate floors).

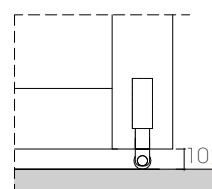

From 6 to 20 mm

